

# INSULATED PC SPACERS/SUPPORTS

- Board will be electrically insulated, eliminates need for insulating washers
- Easy snap-in assembly
- No tool required for installation
- Designed for .062 (1.57) thick boards

- One pieces design eliminates the need for additional screws and nuts
- Slim design frees up board space

## TENSION-FIT



- One end permanently attaches to chassis
- Other end secures board with tension fit.
- Board easily releasable for repairs or upgrades

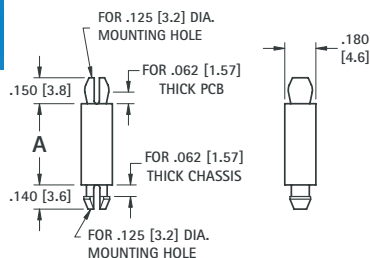

Material: Nylon 6/6, UL Rated 94V-0

CAT. NO.	A LENGTH
8879	.125 (3.2)
8880	.187 (4.7)
8881	.250 (6.4)
8882	.375 (9.5)
8883	.500 (12.7)
8884	.625 (15.9)
8885	.750 (19.1)
8886	.875 (22.2)
8887	1.000 (25.4)

## EASY LOCK-IN



- Both ends permanently attach to chassis and board
- Teardrop style mounting end eases assembly
- Low protrusion above board and under chassis

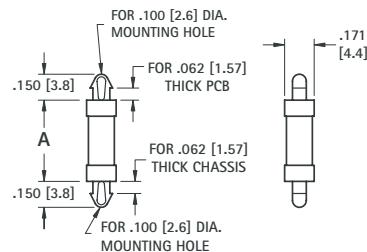

Material: Nylon 6/6, UL Rated 94V-0

CAT. NO.	A LENGTH
8888	.125 (3.2)
8889	.187 (4.7)
8890	.250 (6.4)
8891	.375 (9.5)
8892	.500 (12.7)
8893	.625 (15.9)

## LOCK-IN



- Both ends permanently attach to chassis and board
- Secure mounting end design allows for taller spacing

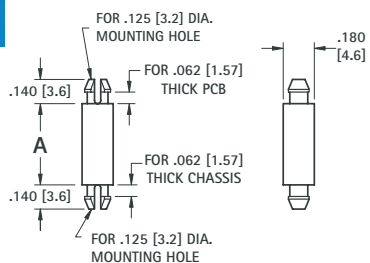

Material: Nylon 6/6, UL Rated 94V-0

CAT. NO.	A LENGTH
9018	.125 (3.2)
9019	.187 (4.7)
9020	.250 (6.4)
9021	.375 (9.5)
9022	.500 (12.7)
9023	.625 (15.9)
9024	.750 (19.1)
9025	.875 (22.2)
9026	1.000 (25.4)

## METRIC LOCK-IN



- Both ends permanently attach to chassis and board
- Designed specifically for metric mounting holes and spacing

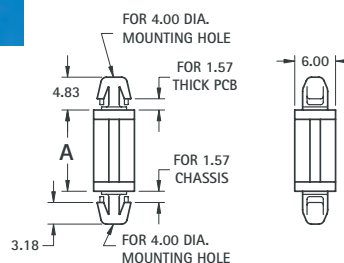

Material: Nylon 6/6, UL Rated 94V-2

CAT. NO.	A LENGTH
8843	3.0
8844	4.0
8845	6.0
8846	8.0
8847	10.0
8848	12.0
8849	14.0
8850	16.0
8851	18.0

## THRU HOLE SPACERS

One end locks into panel. Clear hole designs for #4, #6 or #8 screw.



- Base has larger surface area. Will not deform under heavy pre-load.

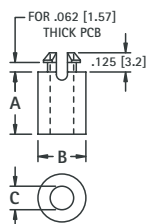

Material: Nylon 6/6, UL Rated 94V-0

CAT. NO.	A LENGTH	Outside Diameter	Inside Diameter	Mounting Hole	Screw Size
9027	.125 (3.2)				
9028	.187 (4.7)				
9029	.250 (6.4)	.260 (6.6)	.125 (3.2)	.187 (4.7)	#4
9030	.375 (9.5)				
9031	.500 (12.7)				
9032	.625 (15.9)				
9033	.250 (6.4)				
9034	.375 (9.5)	.312 (7.9)	.153 (3.9)	.234 (5.9)	#6
9035	.500 (12.7)				
9036	.625 (15.9)				
9037	.250 (6.4)				
9038	.375 (9.5)	.312 (7.9)	.169 (4.3)	.234 (5.9)	#8
9039	.500 (12.7)				
9040	.625 (15.9)				

## STACKING SPACERS

One end locks into panel. Clear hole designs for #4, #6 or #8 screw.



- Spacers can be stacked for multiple level PC board applications
- Self-aligning

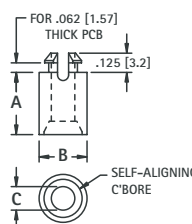

Material: Nylon 6/6, UL Rated 94V-0

CAT. NO.	A LENGTH	Outside Diameter	Inside Diameter	Mounting Hole	Screw Size
8829	.125 (3.2)				
8830	.187 (4.7)				
8831	.250 (6.4)	.260 (6.6)	.125 (3.2)	.187 (4.7)	#4
8832	.375 (9.5)				
8833	.500 (12.7)				
8834	.625 (15.9)				
8835	.250 (6.4)				
8836	.375 (9.5)	.312 (7.9)	.153 (3.9)	.234 (5.9)	#6
8837	.500 (12.7)				
8838	.625 (15.9)				
8839	.250 (6.4)				
8840	.375 (9.5)	.312 (7.9)	.169 (4.3)	.234 (5.9)	#8
8841	.500 (12.7)				
8842	.625 (15.9)				

# INSULATED PC SPACER/SUPPORTS

- Board will be electrically insulated, eliminates need for insulating washers
- No tool required for installation
- Easy snap-in assembly
- One pieces design eliminates the need for additional screws and nuts
- Fits snug onto board
- Accommodates varying board thicknesses
- Flame retardant

## SLIMLINE TENSION-FIT



- One end permanently attaches to .070 (1.78) max. thick chassis
- Other end tension fits to .062 (1.57) max. thick PC board
- Board is easily releasable for repairs or upgrades
- Low insertion force

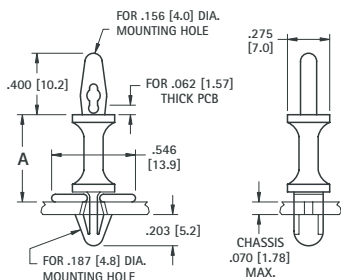

CAT. NO.	A LENGTH
1927A	.250 (6.4)
1928A	.375 (9.5)
1929A	.500 (12.7)
1930A	.625 (15.9)
1931A	.750 (19.1)
1932A	.875 (22.2)
1933A	1.000 (25.4)

Material: Nylon 6/6, UL Rated 94V-0

## SLIMLINE LOCK-IN



- One end permanently attaches to .070 (1.78) max. thick chassis
- Other end permanently attaches to .062 (1.57) max. thick PC board
- Low insertion force
- Small footprint frees up board space.

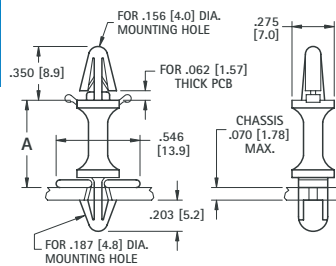

CAT. NO.	A LENGTH
1927B	.250 (6.4)
1928B	.375 (9.5)
1929B	.500 (12.7)
1930B	.625 (15.9)
1931B	.750 (19.1)
1932B	.875 (22.2)
1933B	1.000 (25.4)

Material: Nylon 6/6, UL Rated 94V-0

## STURDY TENSION-FIT



- One end permanently attaches to .031(.79) - .078 (2.0) thick chassis
- Other end tension fits to .062 (1.57) max thick PC board
- Board is easily releasable for repairs or upgrades
- Sturdy support due to high contact area

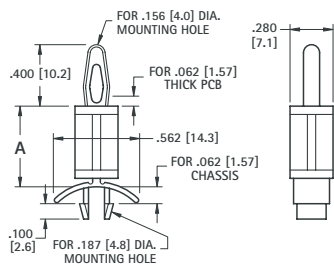

CAT. NO.	A LENGTH
8800	.187 (4.7)
8801	.250 (6.4)
8802	.375 (9.5)
8803	.500 (12.7)
8804	.625 (15.9)
8805	.750 (19.1)
8806	.875 (22.2)

Material: Nylon 6/6, UL Rated 94V-0

## STURDY LOCK-IN



- Both ends permanently attaches to .031 (.79) - .078 (2.0) thick chassis or board
- Sturdy support due to high contact area

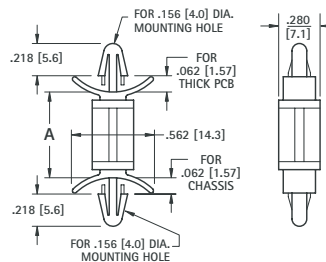

CAT. NO.	A LENGTH
8815	.187 (4.7)
8816	.250 (6.4)
8817	.375 (9.5)
8818	.500 (12.7)
8819	.625 (15.9)
8820	.750 (19.1)
8821	.875 (22.2)

Material: Nylon 6/6, UL Rated 94V-0

## STURDY LOCK-IN RELEASE



- Locks onto .062 (1.57) thick PC board
- Board is positively locked until manually released
- Board is easily releasable for repairs or upgrades
- Sturdy support due to high contact area with chassis

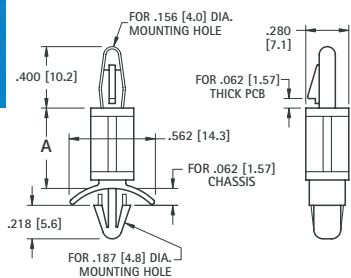

CAT. NO.	A LENGTH
8807	.187 (4.7)
8808	.250 (6.4)
8809	.375 (9.5)
8810	.500 (12.7)
8811	.625 (15.9)
8812	.750 (19.1)
8813	.875 (22.2)
8814	1.000 (25.4)

Material: Nylon 6/6, UL Rated 94V-0

## SLIMLINE LOCK-IN RELEASE



- Locks onto .062 (1.57) thick PC board
- Board is positively locked until manually unlocked
- Board is easily releasable for repairs or upgrades
- Compact design uses smaller mounting holes

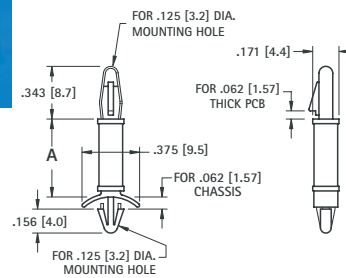

CAT. NO.	A LENGTH
8871	.187 (4.7)
8872	.250 (6.4)
8873	.375 (9.5)
8874	.500 (12.7)
8875	.625 (15.9)

Material: Nylon 6/6, UL Rated 94V-0

# INSULATED PC SPACERS/SUPPORTS

- Board will be electrically insulated, eliminates need for insulating washers
- No tool required for installation • Easy snap-in assembly

## LOCK-IN RELEASE THREADED SUPPORTS

- One end attaches to chassis with self tapping screw or nut
- Other end snap locks onto .062 (1.57) thick PC board
- Board is easily releasable, for repairs or upgrades
- Threaded mount provides an extremely strong hold to the chassis

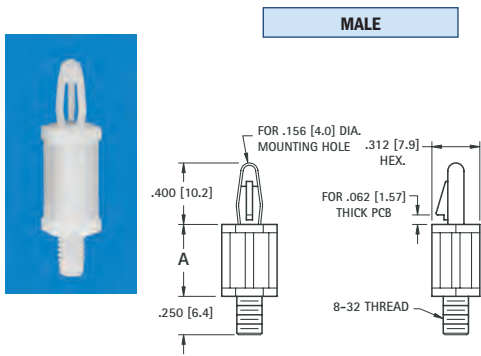

CAT. NO.	A LENGTH
9048	.250 (6.4)
9049	.375 (9.5)
9050	.500 (12.7)
9051	.625 (15.9)
9052	.750 (19.1)
9053	.875 (22.2)
9054	1.000 (25.4)

Material: Nylon 6/6, UL Rated 94V-0

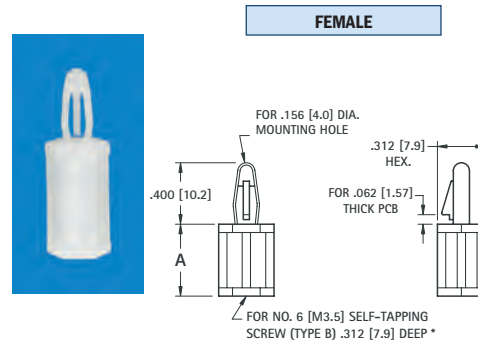

CAT. NO.	A LENGTH
9041	.250 (6.4)
9042	.375 (9.5)
9043	.500 (12.7)
9044	.625 (15.9)
9045	.750 (19.1)
9046	.875 (22.2)
9047	1.000 (25.4)

Material: Nylon 6/6, UL Rated 94V-0

## PC SPACER SUPPORTS

- One attaches end locks into chassis • Other end supports the PC Board
- Ideal for mid supports of large boards
- Simplifies assembly for multiple support applications • Reduces the amount of holes required in PC board

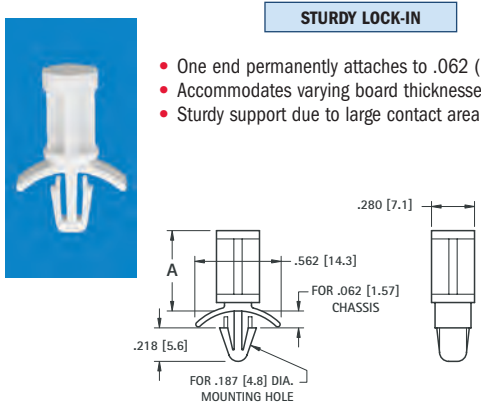

CAT. NO.	A LENGTH
8822	.187 (4.7)
8823	.250 (6.4)
8824	.375 (9.5)
8825	.500 (12.7)
8826	.625 (15.9)
8827	.750 (19.1)
8828	.875 (22.2)

Material: Nylon 6/6, UL Rated 94V-0

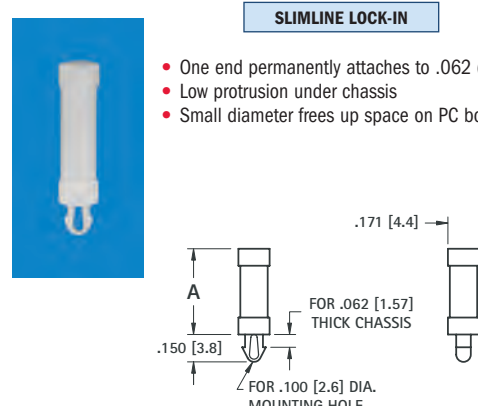

CAT. NO.	A LENGTH
9055	.125 (3.2)
9056	.187 (4.7)
9057	.250 (6.4)
9058	.375 (9.5)
9059	.500 (12.7)
9060	.625 (15.9)

Material: Nylon 6/6, UL Rated 94V-0

## REVERSE CHASSIS MOUNT SUPPORTS

- Permanently attaches to .059 (1.51) - .065 (1.65) thick case from outside
- Provides flat clean cosmetic appearance • Ideal for low clearance applications or for mounting directly to case walls

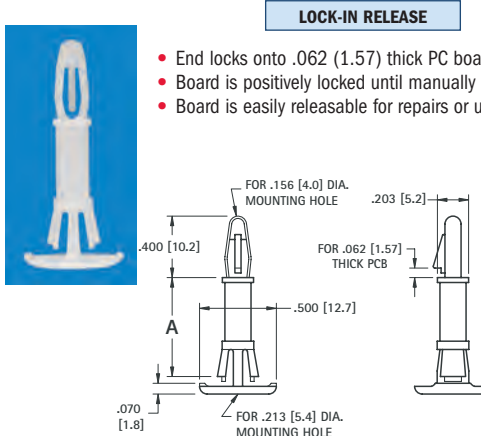

CAT. NO.	A LENGTH
9061	.250 (6.4)
9062	.375 (9.5)
9063	.500 (12.7)
9064	.625 (15.9)

Material: Nylon 6/6, UL Rated 94V-0

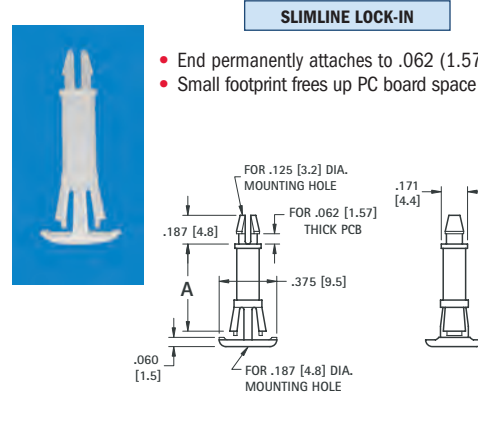

CAT. NO.	A LENGTH
9065	.250 (6.4)
9066	.375 (9.5)
9067	.500 (12.7)
9068	.625 (15.9)

Material: Nylon 6/6, UL Rated 94V-0

INSULATED PC SPACERS/SUPPORTS