

FUSE CLIPS

- PC thru mount, surface mount and rivet types for 5mm, 1AG, 2AG, 3AG, 4AG, 5AG, 7AG & 8AG fuse sizes
- Low contact resistance
- Withstands shock and vibration
- Rated 6.3 to 30 Amps
- Custom designs and modifications available to your specifications

PC THRU MOUNT TYPES

- Available for 5mm, 1AG, 2AG, 3AG, 5AG, 7AG & 8AG sizes
- Low profile, space saving
- Snap-fit design enhances assembly and PC retention for wave soldering
- Available with orientation legs to assure proper PC installation
- Available with or without end stops

SURFACE MOUNT & RIVET TYPES

- Available for 5mm, 1AG, 2AG, 3AG, 4AG, 7AG & 8AG sizes
- Available with straight or 45° solder lugs
- Available with .187 (4.7), .205 (5.2) or .250 (6.4) or quick-fit tabs
- Low profile, space saving
- Available with or without end stops

Refer to pages 38-40 for Fuse Clip Layout and Mounting Details

5mm PC Clips



3517 3518P

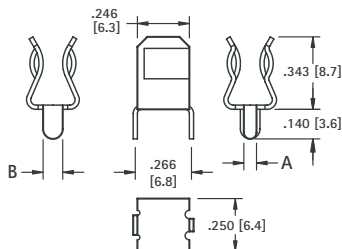

With or Without Orientation Legs

MATERIAL:

.020 (.51) thick Brass, Tin Plate

Current Rating: 15 Amps

CAT. NO.	A	B
3517	.060 (1.5)	.060 (1.5)
3518P	.060 (1.5)	.093 (2.4)



3512 3512P

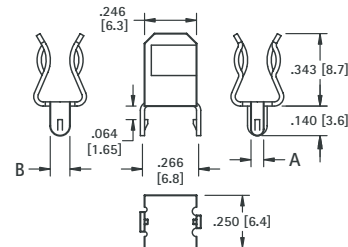

With or Without Orientation Legs

- With snap-in PC legs

MATERIAL:

.020 (.51) thick Brass, Tin Plate

Current Rating: 15 Amps

CAT. NO.	A	B
3512	.060 (1.5)	.060 (1.5)
3512P	.060 (1.5)	.093 (2.4)

FUSE CLIPS

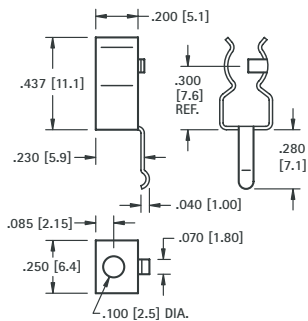

MATERIAL:

.016 (.41) thick Brass, Tin Plate

Current Rating: 6.3 Amps

CAT. NO. 3520

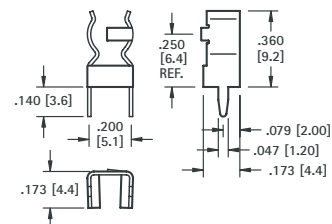

MATERIAL:

.016 (.41) thick Brass, Tin Plate

Current Rating: 10 Amps

CAT. NO. 3519

Mounting Detail

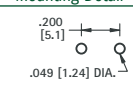

For 2AG or 5mm



3521 3561

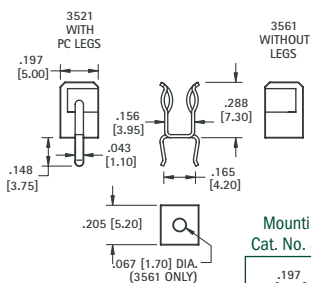

Mounting Detail Cat. No. 3521 Only

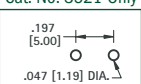

MATERIAL:

.016 (.41) thick Brass, Tin Plate

Current Rating: 10 Amps

CAT. NO. 3521 (THM with PC Legs)

CAT. NO. 3561 (SMT with Hole)

For 5mm/3AG

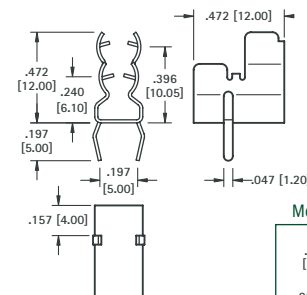

Mounting Detail

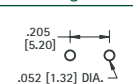

MATERIAL:

.016 (.41) thick Brass, Tin Plate

Current Rating: 15 Amps

CAT. NO. 3562

For 4AG (9/32 Dia.)

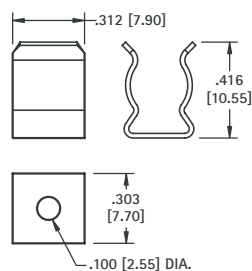

MATERIAL:

.020 (.51) thick Brass, Nickel Plate

Current Rating: 15 Amps

CAT. NO. 3565 (Without End Stops)

For 5AG (13/32 Dia.)

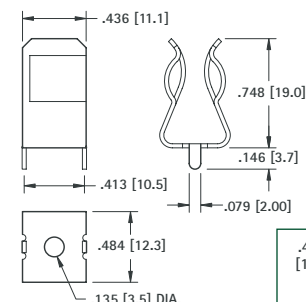

Mounting Detail

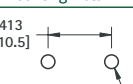

MATERIAL:

.030 (.76) thick Brass, Tin Plate

Current Rating: 30 Amps

CAT. NO. 3566

5mm FUSE HOLDERS

SLIM LINE & OPTIONAL COVER

• For 5mm x 20mm Fuse

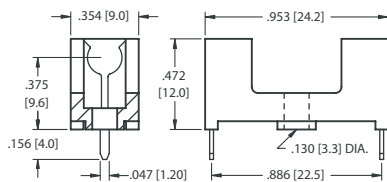

Mounting Detail

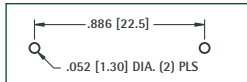

SPECIFICATIONS

Base & Cover: Nylon,
UL Rated 94V-0
Clips: Brass, Tin Plate
Rated: 5 Amps @ 250V AC

CAT. NO. 4628 - Holder

CAT. NO. 4628C - Cover only (with window)

- Optional cover with window protects and insulates fuse
- Flame Retardant

LOW PROFILE & OPTIONAL COVER

• For 5mm x 20mm Fuse

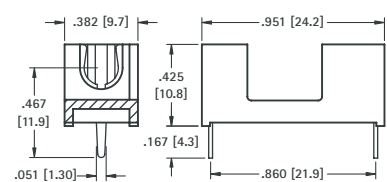

Mounting Detail

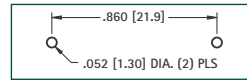

SPECIFICATIONS

Base & Cover: Nylon,
UL Rated 94V-0
Clips: Brass, Tin Plate
Rated: 5 Amps @ 250V AC

CAT. NO. 4527 - Holder

CAT. NO. 4527C - Cover only

- Low profile, space saving design
- Optional cover protects and insulates fuse
- Flame Retardant

FULLY INSULATED

• For 5mm x 20mm Fuse

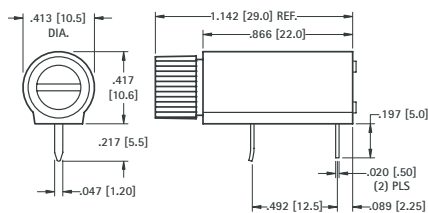

Mounting Detail

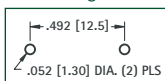

SPECIFICATIONS

Base: PBT
Contacts: Brass, Tin Plate
Rated: 10 Amps @ 250V AC

CAT. NO. 4525

- Shock resistant
- Ideal for board edge designs
- Fuse can be accessed from board edge
- Fuse is completely enclosed, protecting fuse from shorting and breaking
- End cap and body supplied unassembled

PC SNAP-IN FUSE HOLDER

• For 5mm x 20mm Fuse

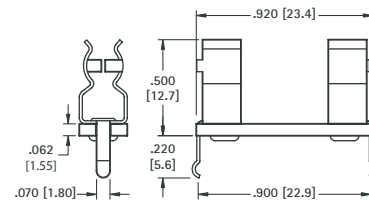
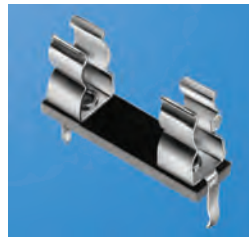

Mounting Detail

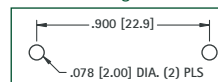

SPECIFICATIONS

Base: .062 (1.57) G-10, UL Rated 94V-0
Clips: Brass, Tin Plate
Rated: 6.3 Amps @ 250V AC

CAT. NO. 3527 - Holder

- Snap-in design for wave soldering
- Flame Retardant
- Optional cover protects and insulates fuse - **Cat. No. 3527C**

5mm & 3AG FUSE HOLDERS

3AG FUSE HOLDERS

- For 3AG Fuses .250 x 1.250 (6.35 x 31.8)
- Provides greater mechanical strength than individual clips
- Flame Retardant
- One piece construction assures proper fuse clip orientation which also increases production efficiency
- **Rated:** 15 Amps @ 500V AC

TERMINATION LUGS CAN BE USED WITH WIRES OR PC MOUNT

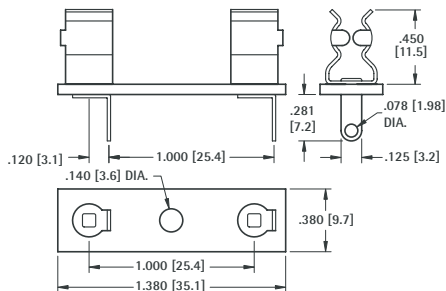

Mounting Detail

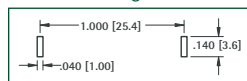

SPECIFICATIONS

Base: .062 (1.57) GPO-3,
UL Rated 94V-0
Clips: Brass, Tin Plate

CAT. NO. 3526

Optional cover available - **Cat. No. 4245C**

PRESS-FIT, IDEAL FOR WAVE SOLDERING

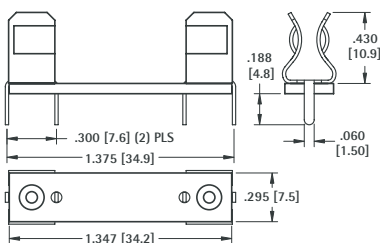

Mounting Detail

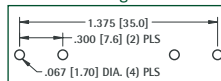

SPECIFICATIONS

Base: .062 (1.57) GPO-3,
UL Rated 94V-0
Clips: Brass, Tin Plate

CAT. NO. 4245

Optional cover available - **Cat. No. 4245C**

SNAP-IN DESIGN ASSURES STABILITY DURING WAVE SOLDERING

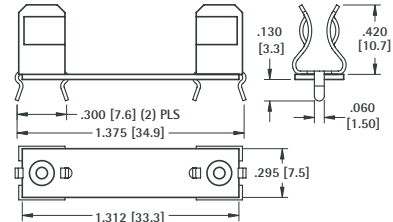

Mounting Detail

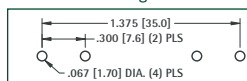

SPECIFICATIONS

Base: .032 (1.57) G-10,
UL Rated 94V-0
Clips: Brass, Tin Plate

CAT. NO. 4250

Optional cover available - **Cat. No. 4245C**

.250 (6.4) DIAMETER FUSE CLIPS

Refer to pages 38-40 for Fuse Clip Layout and Mounting Details

For 1AG, 3AG, 7AG, 8AG THRU HOLE MOUNT TYPES

WITH SNAP-IN PC LEGS



MATERIAL:
.020 (.51) thick Brass, Tin Plate
Current Rating: 15 Amps

CAT. NO. 3513

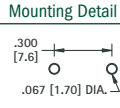
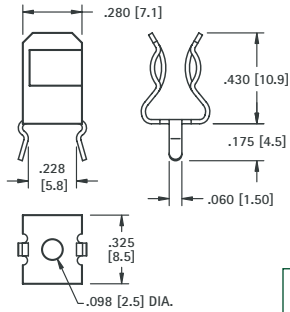

WITH SNAP-IN PC LEGS

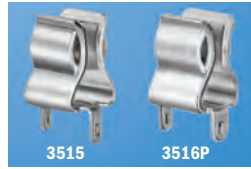

MATERIAL:
.020 (.51) thick Brass, Tin Plate
Current Rating: 15 Amps

CAT. NO.	A	B
3515	.060 (1.5)	.060 (1.5)
3515P	.060 (1.5)	.093 (2.4)
3516P	.060 (1.5)	.120 (3.0)

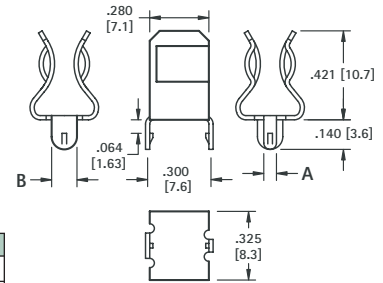

With or Without Orientation Legs

WITH STRAIGHT PC LEGS



MATERIAL:
.020 (.51) thick Brass, Tin Plate
Current Rating: 15 Amps

CAT. NO. 3530

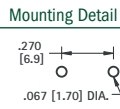
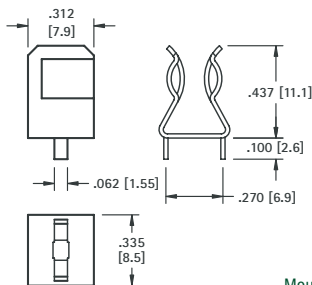

WITH STRAIGHT PC LEGS



MATERIAL:
.020 (.51) thick Brass, Tin Plate
Current Rating: 15 Amps

CAT. NO.	H	L	END STOPS
3510	.421 (10.7)	.140 (3.6)	NO
3529	.421 (10.7)	.140 (3.6)	YES
3511	.430 (10.9)	.250 (6.4)	NO
3514	.430 (10.9)	.250 (6.4)	YES

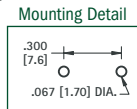
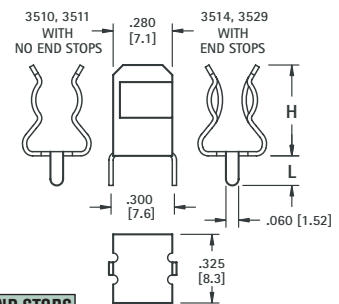

WITH SOLDER LUG

For 1AG, 3AG, 7AG, 8AG RIVET & SURFACE MOUNT TYPES



MATERIAL:
.020 (.51) thick Brass, Nickel Plate
Current Rating: 15 Amps

CAT. NO.	A	B
3533	Flat	.656 (16.7)
3535	45°	.562 (14.3)
3570	-	NO TAB

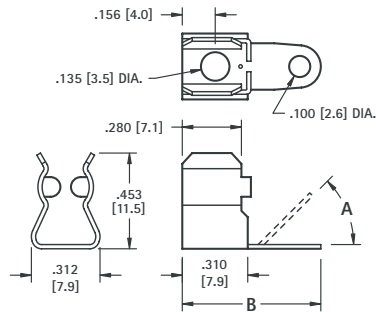

LOW PROFILE



MATERIAL:
.020 (.51) thick Brass, Nickel Plate
Current Rating: 15 Amps

CAT. NO. 3531 (Without End Stops)

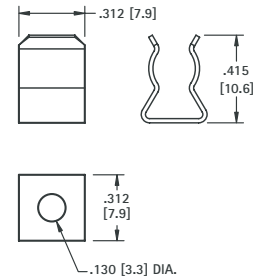

WITH QUICK-FIT TAB



MATERIAL:
.020 (.51) thick Brass, Nickel Plate
Current Rating: 15 Amps

CAT. NO.	A	B
4246	.020 (0.5)	.187 (4.7)
4247	.020 (0.5)	.205 (5.2)
4244	.032 (0.8)	.250 (6.4)

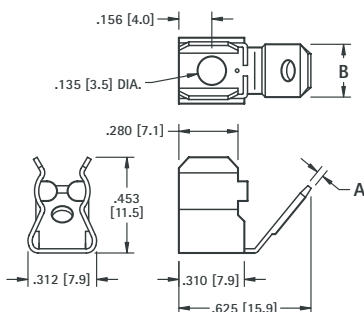

WITH OR WITHOUT END STOPS



MATERIAL:
.020 (.51) thick Brass, Nickel Plate
Current Rating: 15 Amps

CAT. NO.	END STOPS
3532	YES
3567	NO

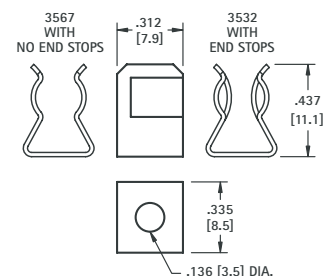

3AG RIVET TYPE FUSE HOLDERS

- Available in Flame Retardant fiberglass base or Phenolic base
- Fuse clips riveted to .125 (3.2) thick base for rugged applications

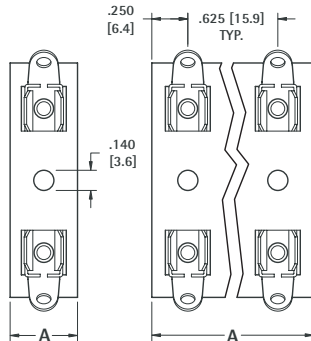
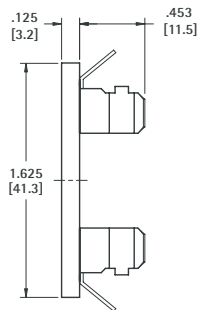

FIG. 1

FIG. 2

SPECIFICATIONS

Black Phenolic Base: .125 (3.2) thick NEMA Grade XP & FED L-P-509. Max. operating temperature 266°F (130°C) continuous. UL Rated 94-HB

Fiberglass Base: .125 (3.2) thick NEMA Grade GPO 3. Max. operating temperature 300°F (148°C) continuous. UL Rated 94V-0, Flame Retardant

Clips: Brass, Nickel Plate (Cat. No. 3535)

Rated: 15 Amps @ 500V AC

BLACK PHENOLIC CAT. NO.	FIBER-GLASS CAT. NO.	HOLDS NO. OF FUSES	FIG. NO.	A
3536	3540	1	1	.500 (12.7)
3537	3541	2	2	1.125 (28.6)
3538	3542	3	2	1.750 (44.5)
3539	3543	4	2	2.375 (60.3)

MOLDED 3AG FUSE HOLDERS

- Quick-Fit Tab, .250 (6.4) × .032 (.81) size, accepts standard .250 (6.4) quick-fit female terminals. Eliminates the need for soldering
- Available with solder lugs or .250 (6.4) Quick-Fit Tabs
- Molded with barriers to prevent and withstand test of 1080 VRMS at 60Hz for 1 minute at 3000V DC
- Flame Retardant

SPECIFICATIONS

Molded Base: LCP, UL Rated 94V-0.

Clips: Brass, Nickel Plate

Rated: 15 Amps @ 500V AC



SOLDER LUG

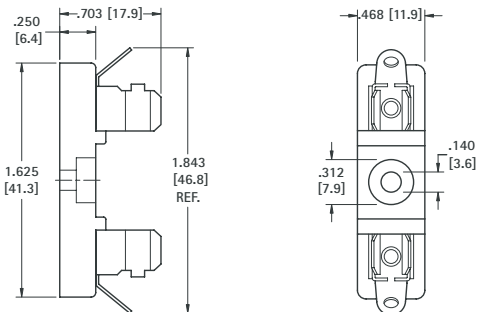

Assembled with Clip, Cat. No. 3535

CAT. NO. 3523

QUICK-FIT

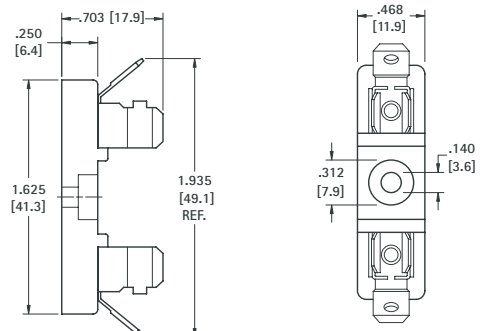

Assembled with Clip, Cat. No. 4244

CAT. NO. 4243

3AG FUSE HOLDERS

5mm & 3AG FUSE COVERS

5mm

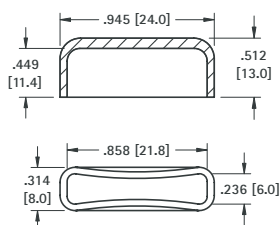

CAT. NO. 3527C

MATERIAL: PVC, UL Rated 94V-0

3AG

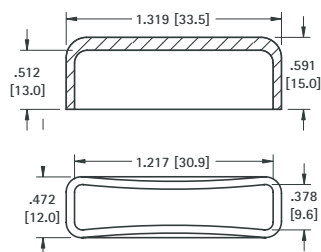

CAT. NO. 4245C

MATERIAL: PVC, UL Rated 94V-0