

TURRET TERMINAL BOARDS

• Save Tooling • Economical • Complete Range of Sizes

Readi-Made Terminal Boards: Low cost, meets commercial and military specifications. Produced in large quantities, making it possible to eliminate tooling and setup charges usually applied to non-standard boards.

BOARDS ON THIS PAGE ARE NOT SCORED

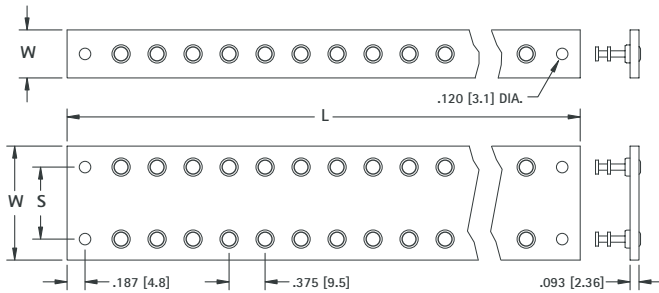
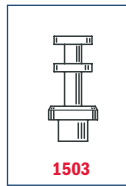
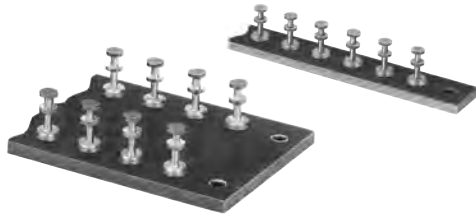

Terminals are staked in all holes except end mounting holes.

MATERIAL: Choice of either PBE or GEE.

PBE: Paper base electrical, MIL-1-24768/20, Type XP natural, Temp. 250°F (121°C) max.

GEE: Glass epoxy, MIL-1-24768/27, Type G-10, Temp. 300°F (155°C) max.

Terminals: Brass, ASTM-B16. Tin Plate, MIL-T-10727. Other plating can be furnished.

MODIFICATIONS

Boards can be modified with other materials or terminals of your choice. Marking can also be added. Quotations upon request.

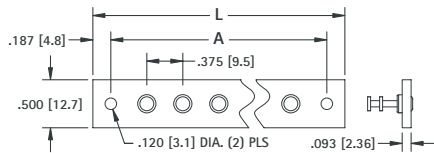

Terminals are staked in all holes except end mounting holes.

MATERIAL: PBE

PBE: Paper base electrical, FED. LP-513, Type XP natural, Temp. 250°F (121°C) max.

Terminals: Brass, ASTM-B16. Tin Plate, MIL-T-10727.

Other plating can be furnished.

W	S	L	NO. OF TERMS EACH SIDE	MATERIAL PBE CAT. NO.	MATERIAL GEE CAT. NO.
.500 [12.7]	Single Row	2.625 (66.7)	5	15101	15301
		5.250 (133.4)	12	15102	15302
		7.875 (200.0)	19	15103	15303
		10.500 (266.7)	26	15104	15304
		13.125 (333.4)	33	15105	15305
1.188 (30.2)	.750 (19.1)	2.625 (66.7)	5	15106	15306
		5.250 (133.4)	12	15107	15307
		7.875 (200.0)	19	15108	15308
		10.500 (266.7)	26	15109	15309
		13.125 (333.4)	33	15110	15310
1.500 (38.1)	1.000 (25.4)	2.625 (66.7)	5	15111	15311
		5.250 (133.4)	12	15112	15312
		7.875 (200.0)	19	15113	15313
		10.500 (266.7)	26	15114	15314
		13.125 (333.4)	33	15115	15315
2.000 (50.8)	1.500 (38.1)	2.625 (66.7)	5	15116	15316
		5.250 (133.4)	12	15117	15317
		7.875 (200.0)	19	15118	15318
		10.500 (266.7)	26	15119	15319
		13.125 (333.4)	33	15120	15320
2.500 (63.5)	2.000 (50.8)	2.625 (66.7)	5	15121	15321
		5.250 (133.4)	12	15122	15322
		7.875 (200.0)	19	15123	15323
		10.500 (266.7)	26	15124	15324
		13.125 (333.4)	33	15125	15325
3.000 (76.2)	2.500 (63.5)	2.625 (66.7)	5	15126	15326
		5.250 (133.4)	12	15127	15327
		7.875 (200.0)	19	15128	15328
		10.500 (266.7)	26	15129	15329
		13.125 (333.4)	33	15130	15330

	1503	1509	1545	1507
	1503	Hole thru 1509	1545	Hole thru 1507
	CAT. NO.	CAT. NO.	CAT. NO.	CAT. NO.
L	A	NO. OF TERMS	CAT. NO.	CAT. NO.
1.125 (28.6)	.750 (19.1)	1	603-1	607-1
1.500 (38.1)	1.125 (28.6)	2	603-2	607-2
1.875 (47.6)	1.500 (38.1)	3	603-3	607-3
2.250 (57.2)	1.875 (47.6)	4	603-4	607-4
2.625 (66.7)	2.250 (57.2)	5	603-5	607-5
3.000 (76.2)	2.625 (66.7)	6	603-6	607-6
3.375 (85.7)	3.000 (76.2)	7	603-7	607-7
3.750 (95.3)	3.375 (85.7)	8	603-8	607-8
4.125 (104.8)	3.750 (95.3)	9	603-9	607-9
4.500 (114.3)	4.125 (104.8)	10	603-10	607-10

QUICK-FIT TERMINAL STRIPS

MATERIAL: Fiberglass - NEMA GRADE GPO-3.

A glass polyester rated for continuous operation at 300°F (155°C) .062 (1.57) thick

Backing Strips: .031 (.79) thick fibre with mounting holes drilled only

Terminals: Brass

CAT. NO. 1254 .018 (.46) thick Bright Electro Tin MIL-F-14072

CAT. NO. 1257 .032 (.81) thick Bright Brass
Other platings available on special order

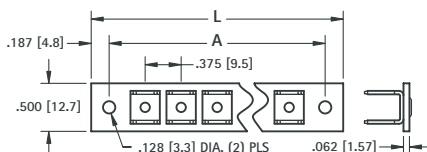
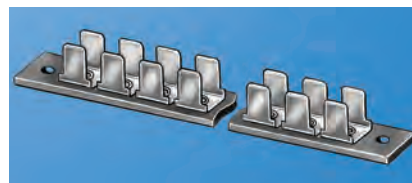

.205 (5.2) TABS		.250 (6.4) TABS		.205 TAB	BACKING INSULATOR .031 (.79) THICK FIBER		.250 TAB
				1254			1257
L LENGTH	A MTG. CENTERS	NO. TERM. EACH SIDE	CAT. NO.	CAT. NO.	CAT. NO.	CAT. NO.	
1.500 (38.1)	1.125 (28.6)	2	4056	4401	4116		
2.250 (57.2)	1.875 (47.6)	4	4057	4402	4117		
3.000 (76.2)	2.625 (66.7)	6	4058	4403	4118		
3.750 (95.3)	3.375 (85.7)	8	4059	4404	4119		
4.500 (114.3)	4.125 (104.8)	10	4060	4405	4120		

TERMINAL BOARDS & STRIPS

TERMINAL STRIPS (STANDARD & MINIATURE)

Tin plated lugs and brackets. Bakelite XP .062 (1.57) thick. In addition to the strips shown, we manufacture many other varieties in any configuration and materials required. Send samples or sketch for prompt quotation.

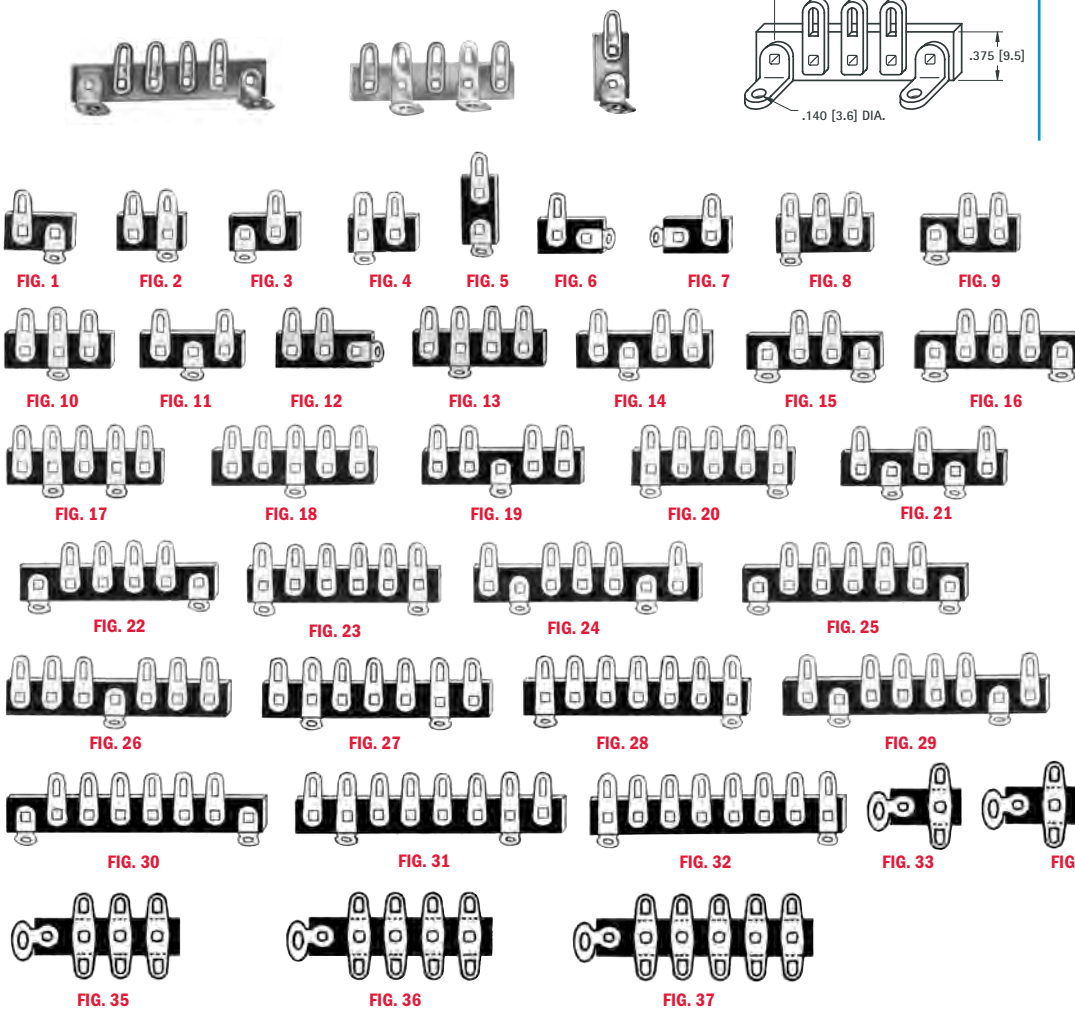

STANDARD

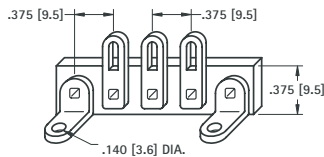

MINIATURE

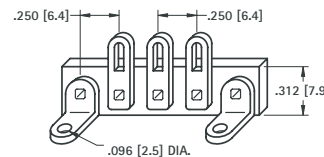

STANDARD CAT. NO.	FIG NO.	MINIATURE CAT. NO.
800	1	837
801	2	838
802	3	839
803	4	840
804	5	841
805	6	842
806	7	843
807	8	844
808	9	845
809	10	846
810	11	847
811	12	848
812	13	849
813	14	850
814	15	851
815	16	852
816	17	853
817	18	854
818	19	855
819	20	856
820	21	857
821	22	858
822	23	859
823	24	860
824	25	861
825	26	862
826	27	863
827	28	864
828	29	865
829	30	866
830	31	867
831	32	868
832	33	—
833	34	—
834	35	—
835	36	—
836	37	—

BINDING POST STRIPS

FIBERGLASS: Reinforced Polyester NEMA Grade GPO-3 rated for 300°F (155°C).

GEE: Glass Epoxy, MIL-I-24768/27 Type G-10. Temp. 300°F (155°C).

PBE: Paper base electrical, MIL-1-24768/20 Type XP natural, Temp 250°F (121°C) max..

SPECIFICATIONS

STANDARD

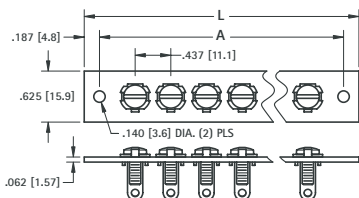

PBE CAT. NO.	GEE CAT. NO.	FIBER-GLASS CAT. NO.	L LENGTH	A MTG. CENTERS	NO. OF TERM
4187	4177	4167	1.250 (31.8)	.875 (22.2)	1
4188	4178	4168	1.687 (42.8)	1.312 (33.3)	2
4189	4179	4169	2.125 (54.0)	1.750 (44.5)	3
4190	4180	4170	2.562 (65.1)	2.187 (55.5)	4
4191	4181	4171	3.000 (76.2)	2.625 (66.7)	5
4192	4182	4172	3.437 (87.3)	3.062 (77.8)	6
4193	4183	4173	3.875 (98.4)	3.500 (88.9)	7
4194	4184	4174	4.312 (109.5)	3.937 (100.0)	8
4195	4185	4175	4.750 (120.7)	4.375 (111.1)	9
4196	4186	4176	5.187 (131.7)	4.812 (122.2)	10

Terminals supplied on these strips



Refer to page 57 for Part details on Cat. No.1248

HEAVY DUTY

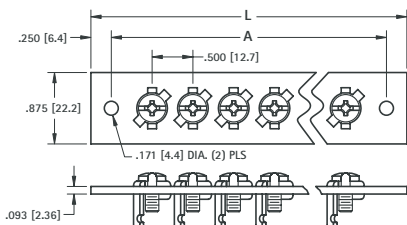

GEE CAT. NO.	FIBER-GLASS CAT. NO.	L LENGTH	A MTG. CENTERS	NO. OF TERM
4147	4157	1.50 (38.1)	1.00 (25.4)	1
4148	4158	2.00 (50.8)	1.50 (38.1)	2
4149	4159	2.50 (63.5)	2.00 (50.8)	3
4150	4160	3.00 (76.2)	2.50 (63.5)	4
4151	4161	3.50 (88.9)	3.00 (76.2)	5
4152	4162	4.00 (101.6)	3.50 (88.9)	6
4153	4163	4.50 (114.3)	4.00 (101.6)	7
4154	4164	5.00 (127.0)	4.50 (114.3)	8
4155	4165	5.50 (139.7)	5.00 (127.0)	9
4156	4166	6.00 (152.4)	5.50 (139.7)	10

Terminals supplied on these strips



Refer to page 56 for Part details on Cat. No.1209