



Underwriters Laboratories, Inc.
Recognized Component Program — UL File Number E201546

UL file number E201546 has been assigned to Keystone Electronics' "Quick-Fit" terminals (Refer to pages 44-47) indicating recognition by Underwriters Laboratories Inc. that they are in compliance with their component program.

Underwriters Laboratories Inc. component program assures that "Quick-Fit" terminals meet the dimensional and performance requirements of the National Electrical Manufacturers Association specification number NEMA2-1982-(1988) and UL310.



.110 (2.8), .187 (4.8), .205 (5.2) MALE TABS

.110 (2.8) TAB

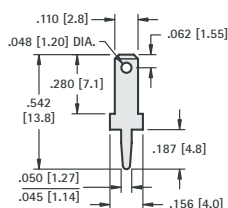

CAT. NO.	MATERIAL	MTG. HOLE
1267	.020 (.50) Brass, Tin Plate	.046 (1.2) Dia.
1211	.032 (.80) Brass, Tin Plate	.052 (1.3) Dia.

.110 (2.8) TAB

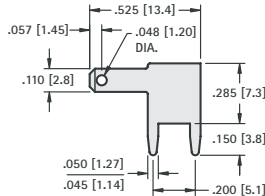

CAT. NO.	MATERIAL	MTG. HOLES
4903	.020 (.50) Brass, Tin Plate	.046 (1.2) Dia.
4906	.032 (.80) Brass, Tin Plate	.052 (1.3) Dia.

.187 (4.8) TAB

STURDI-MOUNT

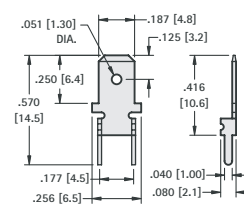

CAT. NO.	MATERIAL	MTG. HOLES
4900	.020 (.50) Brass, Tin Plate	.043 (1.1) Dia.

.187 (4.8) TAB

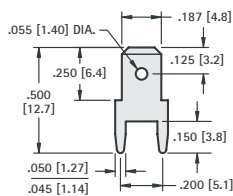

CAT. NO.	MATERIAL	MTG. HOLES
1285	.020 (.50) Brass, Tin Plate	.046 (1.2) Dia.
1212	.032 (.80) Brass, Tin Plate	.052 (1.3) Dia.

.187 (4.8) TAB

STURDI-MOUNT

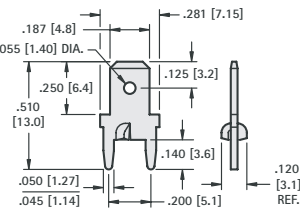

CAT. NO.	MATERIAL	MTG. HOLES
1285-ST	.020 (.50) Brass, Tin Plate	.046 (1.2) Dia.
1212-ST	.032 (.80) Brass, Tin Plate	.052 (1.3) Dia.

.187 (4.8) TAB

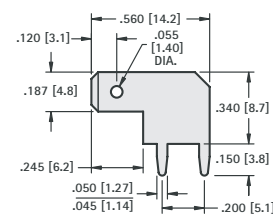

CAT. NO.	MATERIAL	MTG. HOLES
4904	.020 (.50) Brass, Tin Plate	.046 (1.2) Dia.
4907	.032 (.80) Brass, Tin Plate	.052 (1.3) Dia.

.205 (5.2) TAB

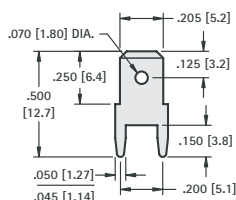

CAT. NO.	MATERIAL	MTG. HOLES
1286	.020 (.50) Brass, Tin Plate	.046 (1.2) Dia.
1213	.032 (.80) Brass, Tin Plate	.052 (1.3) Dia.

.205 (5.2) TAB

STURDI-MOUNT

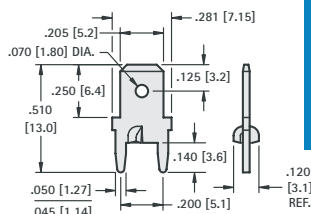

CAT. NO.	MATERIAL	MTG. HOLES
1286-ST	.020 (.50) Brass, Tin Plate	.046 (1.2) Dia.
1213-ST	.032 (.80) Brass, Tin Plate	.052 (1.3) Dia.

.205 (5.2) TAB

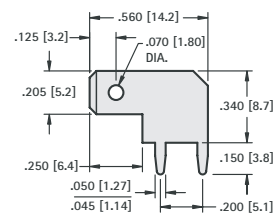

CAT. NO.	MATERIAL	MTG. HOLES
4905	.020 (.50) Brass, Tin Plate	.046 (1.2) Dia.
4909	.032 (.80) Brass, Tin Plate	.052 (1.3) Dia.



.250 (6.4) TAB

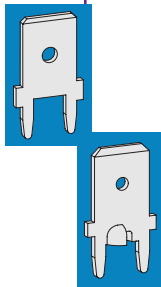
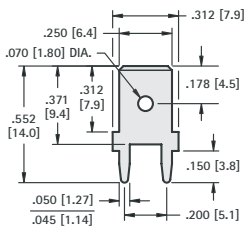

.250 (6.4) TAB

STURDI-MOUNT

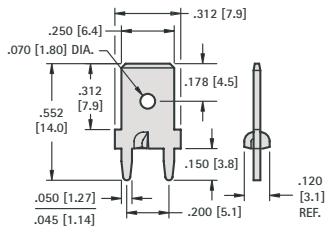

DUAL .110 (2.8)/.250 (6.4) TAB

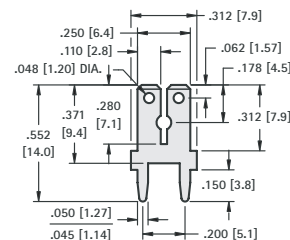

CAT. NO.	MATERIAL	MTG. HOLES
1287	.032 (.80) Brass, Tin Plate	.052 (1.3) Dia.

CAT. NO.	MATERIAL	MTG. HOLES
1287-ST	.032 (.80) Brass, Tin Plate	.052 (1.3) Dia.

CAT. NO.	MATERIAL	MTG. HOLES
1282	.032 (.80) Brass, Tin Plate	.052 (1.3) Dia.

.250 (6.4) TAB

STURDI-MOUNT

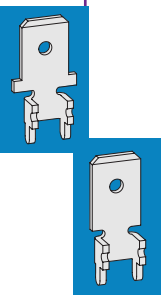
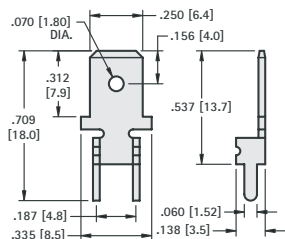

.250 (6.4) TAB

STURDI-MOUNT

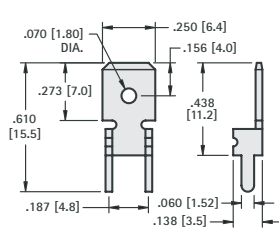

.250 (6.4) TAB

STURDI-MOUNT

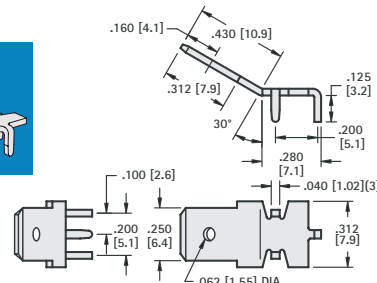

CAT. NO.	MATERIAL	MTG. HOLES
4901	.032 (.80) Brass, Tin Plate	.067 (1.7) Dia.

CAT. NO.	MATERIAL	MTG. HOLES
4902	.032 (.80) Brass, Tin Plate	.067 (1.7) Dia.

CAT. NO.	MATERIAL	MTG. HOLES
4908	.032 (.80) Brass, Tin Plate	.067 (1.7) Dia.

.250 (6.4) TAB

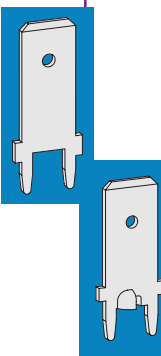
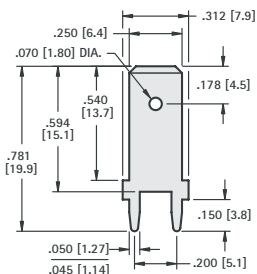

.250 (6.4) TAB

STURDI-MOUNT

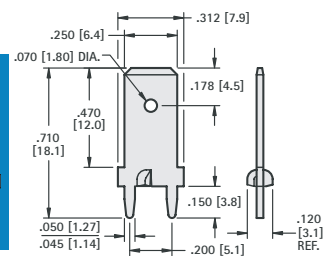

.250 (6.4) TAB

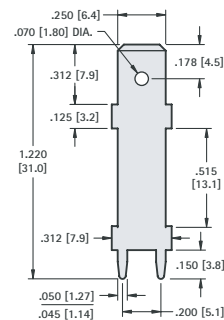

CAT. NO.	MATERIAL	MTG. HOLES
1289	.032 (.80) Brass, Tin Plate	.052 (1.3) Dia.

CAT. NO.	MATERIAL	MTG. HOLES
1289-ST	.032 (.80) Brass, Tin Plate	.052 (1.3) Dia.

CAT. NO.	MATERIAL	MTG. HOLES
1281	.032 (.80) Brass, Tin Plate	.052 (1.3) Dia.

.250 (6.4) TAB

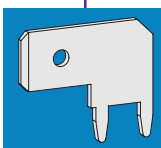
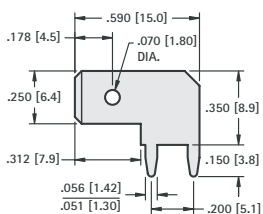

.250 (6.4) TAB

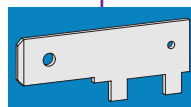
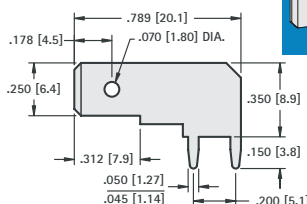

.250 (6.4) TAB

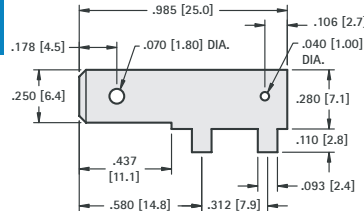

CAT. NO.	MATERIAL	MTG. HOLES
4966	.032 (.80) Brass, Tin Plate	.056 (1.4) Dia.

CAT. NO.	MATERIAL	MTG. HOLES
1266	.032 (.80) Brass, Tin Plate	.052 (1.3) Dia.

CAT. NO.	MATERIAL	MTG. HOLES
1265	.032 (.80) Brass, Tin Plate	.106 (2.7) Dia.

NOTE: .250 TAB HAND INSERTION TOOL: CAT. NO. 1288, REFER TO PAGE 46

.250 (6.4) "STURDI-MOUNT" PC QUICK-FIT HEADERS



AVAILABLE IN BRASS OR STEEL TABS

- Ideal for rugged multi-insertion applications
- Pre-assembled header reduces PC assembly costs
- Increases PC board retention strength
- Keeps terminals perpendicular
- Maintains position for wave soldering

SPECIFICATIONS

Material: .032 (.80) thick Brass or Steel, Tin Plated

Insulator: Thermoplastic, UL Rated 94V-0

Current Rating: 15 Amps @ 500V AC

Temperature Rating: -58°F to +292°F (-50°C to +145°C)



.250 (6.4) HORIZONTAL

BRASS TABS	STEEL TABS	NO. OF TABS	A DIM.
CAT. NO.	CAT. NO.		
7802	7822	2	.362 (9.2)
7803	7823	3	.562 (14.3)
7804	7824	4	.762 (19.4)
7805	7825	5	.962 (24.4)
7806	7826	6	1.162 (29.5)

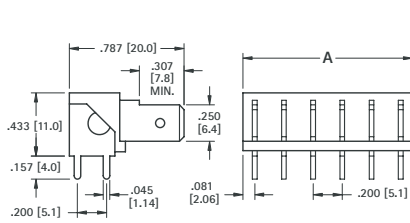

.250 (6.4) VERTICAL

BRASS TABS	STEEL TABS	NO. OF TABS	A DIM.
CAT. NO.	CAT. NO.		
7812	7832	2	.362 (9.2)
7813	7833	3	.562 (14.3)
7814	7834	4	.762 (19.4)
7815	7835	5	.962 (24.4)
7816	7836	6	1.162 (29.5)

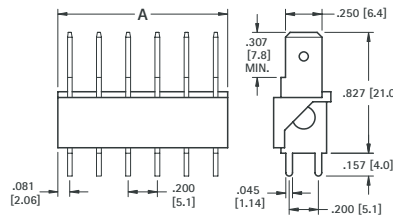

Mtg. Holes: .052 (1.3) Dia. on .200 (5.1) Centers

RIVET MOUNT QUICK-FIT TERMINALS



.110 (2.8) - .187 (4.8) - .250 (6.4) TABS

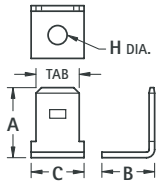

90° TAB

MATERIAL: Bright Brass

CAT. NO.	TAB SIZE	MAT'L THICK	A	B	C	HOLE DIA.
2002	.110 (2.8)	.020 (.51)	.375 (9.5)	.270 (6.9)	.180 (4.6)	.096 (2.4)
1261	.187 (4.8)	.020 (.51)	.375 (9.5)	.250 (6.4)	.250 (6.4)	.099 (2.5)
1256	.250 (6.4)	.032 (.81)	.405 (10.3)	.343 (8.7)	.312 (7.9)	.130 (3.3)

.110 (2.8) - .187 (4.8) - .250 (6.4) TABS

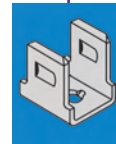
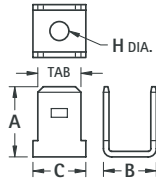

90° TABS

MATERIAL: Bright Brass

CAT. NO.	TAB SIZE	MAT'L THICK	A	B	C	HOLE DIA.
2003	.110 (2.8)	.020 (.51)	.350 (8.9)	.383 (9.7)	.180 (4.6)	.096 (2.4)
1262	.187 (4.8)	.020 (.51)	.312 (7.9)	.250 (6.4)	.250 (6.4)	.099 (2.5)
1257	.250 (6.4)	.032 (.81)	.405 (10.3)	.343 (8.7)	.312 (7.9)	.130 (3.3)

.250 (6.4) TAB

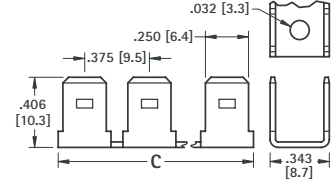

MULTIPLE 90° MATERIAL: Bright Brass

CAT NO.	PAIRS	C	TAB SIZE
1005	2	.687 (17.4)	.250 (6.4)
1006	3	1.062 (27.0)	
1007	4	1.441 (36.6)	
1008	5	1.820 (46.2)	

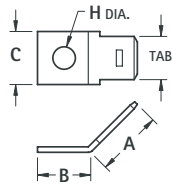

45° TAB

MATERIAL: Bright Brass

CAT. NO.	TAB SIZE	MAT'L THICK	A	B	C	HOLE DIA.
2004	.110 (2.8)	.020 (.51)	.350 (8.9)	.270 (6.9)	.180 (4.6)	.096 (2.4)
1271	.187 (4.8)	.020 (.51)	.375 (9.5)	.250 (6.4)	.250 (6.4)	.099 (2.5)
1280	.250 (6.4)	.032 (.81)	.405 (10.3)	.312 (7.9)	.312 (7.9)	.130 (3.3)

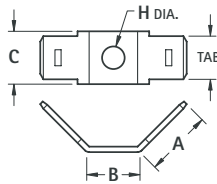

45° TABS

MATERIAL: Bright Brass

CAT. NO.	TAB SIZE	MAT'L THICK	A	B	C	HOLE DIA.
2005	.110 (2.8)	.020 (.51)	.350 (8.9)	.383 (9.7)	.180 (4.6)	.096 (2.4)
1263	.187 (4.8)	.020 (.51)	.312 (7.9)	.375 (9.5)	.265 (6.7)	.099 (2.5)
1258	.250 (6.4)	.032 (.81)	.405 (10.3)	.343 (8.7)	.312 (7.9)	.130 (3.3)

.110 (2.8) TAB

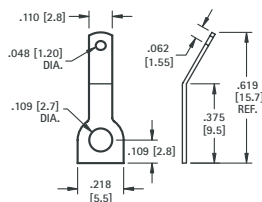

30° TAB

CAT. NO. 1270

MATERIAL: .020 (.51) thick Brass, Tin Plate

.187 (4.8) - .205 (6.4) TABS

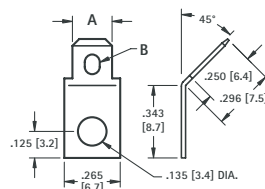

45° TAB MATERIAL: .020 (.51) thick Brass, Tin Plate

CAT. NO.	A	B
4005	.205 (5.2)	.132 (3.4) × .070 (1.78) Slot
4095	.187 (4.7)	.078 (1.98) Dia. Hole

.250 (6.4) MALE TAB INSERTION TOOL

Designed to install .250 (6.4) male "Quick-Fit" terminals quickly and easily. Refer to pages 44 and 45.

- Insert terminal into slot, spring clip will hold terminal securely for positioning
- Align terminal with mounting holes and "press-fit" to secure firmly in place
- Lift tool to release terminal

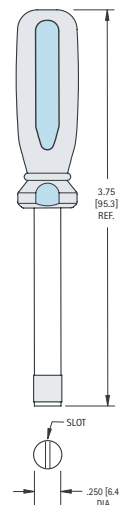

CAT. NO. 1288

FEMALE PC QUICK-FIT TERMINALS

FEMALE PC QUICK-FIT TERMINALS

ACCEPTS .110 (2.8) TAB

HORIZONTAL ENTRY

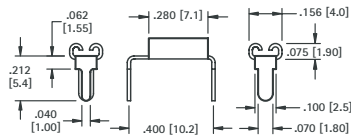

MATERIAL:
.012 (.30) thick Brass,
Tin Nickel Plate

Mounting Detail

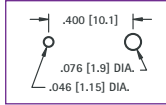

CAT. NO.	ACCEPTS TAB
3545	.110 (2.8) × .020 (.50)
3549	.110 (2.8) × .032 (.80)

ACCEPTS .205 (5.2) TAB

HORIZONTAL ENTRY

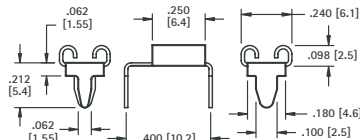

MATERIAL:
.012 (.30) thick Brass,
Tin Nickel Plate

Mounting Detail

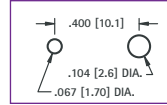

CAT. NO.	ACCEPTS TAB
3546	.205 (5.2) × .020 (.50)
3550	.205 (5.2) × .032 (.80)

ACCEPTS .250 (6.4) TAB

HORIZONTAL ENTRY

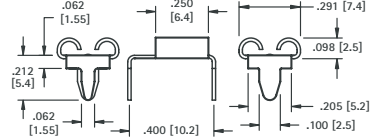

MATERIAL:
.016 (.41) thick Brass,
Tin Nickel Plate

Mounting Detail

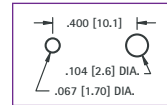

CAT. NO.	ACCEPTS TAB
3547	.250 (6.4) × .032 (.80)

ACCEPTS .110 (2.8) TAB

VERTICAL ENTRY

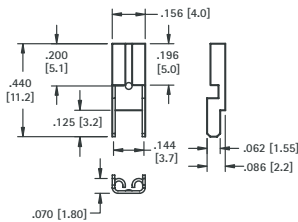

MATERIAL:
.012 (.30) thick Brass,
Tin Nickel Plate

Mounting Detail

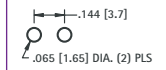

CAT. NO.	ACCEPTS TAB
3534	.110 (2.8) × .020 (.50)
3544	.110 (2.8) × .032 (.80)

ACCEPTS .205 (5.2) TAB

VERTICAL ENTRY

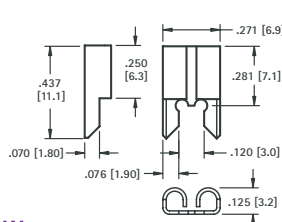

MATERIAL:
Brass, Tin Nickel Plate

Mounting Detail

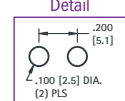

CAT. NO.	ACCEPTS TAB	MAT'L THICK
3525	.205 (5.2) × .020 (.50)	.012 (.30)
3522	.205 (5.2) × .025 (.60)	.016 (.40)
	.205 (5.2) × .032 (.80)	.016 (.40)

ACCEPTS .250 (6.4) TAB

VERTICAL ENTRY

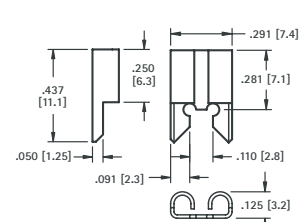

MATERIAL:
.016 (.41) thick Brass,
Tin Nickel Plate

Mounting Detail

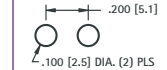

CAT. NO.	ACCEPTS TAB
3528	.250 (6.4) × .032 (.80)

ACCEPTS .187 (4.8) TAB

VERTICAL ENTRY

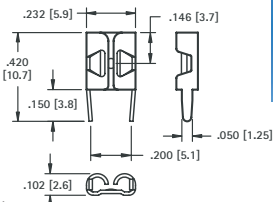
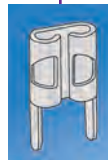

MATERIAL:
.016 (.41) thick
Brass, Tin Nickel Plate

Mounting Detail

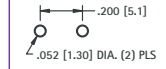

CAT. NO.	ACCEPTS TAB
3548	.187 (4.8) × .020 (.50)
3551	.187 (4.8) × .032 (.80)

ACCEPTS ALL TABS

VERTICAL OR HORIZONTAL ENTRY

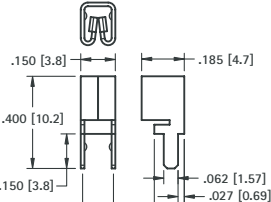

MATERIAL:
.016 (.41) thick Brass,
Tin Nickel Plate

Mounting Detail

CAT. NO.	ACCEPTS TAB
3557	.110 (2.8) to .250 (6.4) × .020 (.50) to .032 (.80)

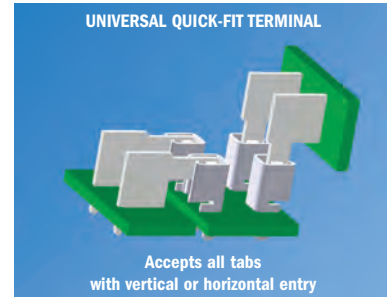

Mounting Detail

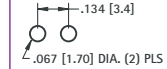

MULTI-PURPOSE HAND TOOL

- This Multi-purpose tool is all that is required to crimp wires into solderless terminals. Refer to pages 48 and 49.

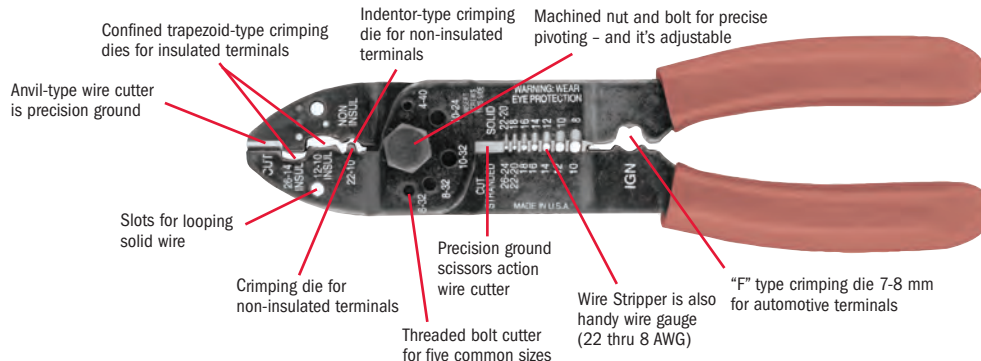

CAT. NO. 1345

Tel (718) 956-8900 • Fax (718) 956-9040
(800) 221-5510 • kec@keyelco.com

KEYSTONE
RoHS COMPLIANT ~ ISO 9001 CERTIFIED

www.keyelco.com
31-07 20th Road - Astoria, NY 11105-2017



QUICK-FIT FEMALES

VINYL BOOT

FEMALE NON-INSULATED

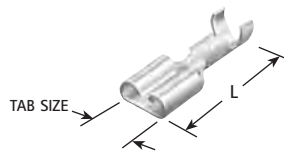

For .250 (6.4) QUICK-FITS

- Easily slips over terminal
- Insulates and protects

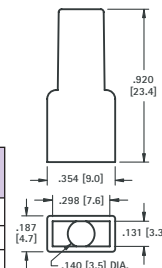

MATERIAL: Tinned Brass

Boot and Quick-Fit sold separately

CAT. NO.	MATES WITH MALE TAB WIDTH × THICK	L	AWG SIZE	MAT'L THICK	CAT. NO.	BOOT COLOR
1252	.110 (2.8) × .020 (.51)	.640 (16.3)	18-22	.010 (.25)	4471	CLEAR
1264	.187 (4.8) × .020 (.51)	.576 (14.6)	16-22	.013 (.33)	4472	RED
4469	.205 (5.2) × .020 (.51)	.640 (16.3)	16-20	.013 (.33)	4473	BLUE
4470	.250 (6.4) × .020 (.51)	.750 (19.1)	16-20	.016 (.41)	4474	YELLOW

SOLDERLESS QUICK-FIT TERMINALS

Solderless terminals are made of pure electrolytic (ETP) copper annealed and tin plated. Insulation is color coded vinyl.

MALE NON-INSULATED

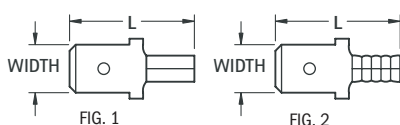

Hand Crimp Tool
CAT. NO. 1345

CAT. NO.	WIRE RANGE (AWG)	FIG.	MALE TAB		L	BARREL	
			WIDTH × THICK	L		LENGTH	I.D.
8281	22/18	2	.187 (4.8) × .020 (.51)	.64 (16.3)	.24 (6.3)	.080 (2.03)	
8282		1	.250 (6.4) × .032 (.81)	.73 (18.5)	.25 (6.4)	.065 (1.65)	
8283	16/14	2	.187 (4.8) × .020 (.51)	.64 (16.3)	.24 (6.3)	.080 (2.03)	
8284		1	.250 (6.4) × .032 (.81)	.73 (18.5)	.25 (6.4)	.085 (2.16)	
8285	12/10	1	.250 (6.4) × .032 (.81)	.75 (19.1)	.25 (6.4)	.150 (3.8)	

FEMALE NON-INSULATED

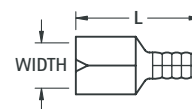

Hand Crimp Tool
CAT. NO. 1345

CAT. NO.	WIRE RANGE (AWG)	MATES WITH MALE TAB		L	BARREL .250 (6.4)	
		WIDTH × THICK	L		I.D.	I.D.
8272	22/18	.187 (4.8) × .020 (.51)	.58 (14.7)	.085 (2.16)		
8273		.250 (6.4) × .032 (.81)	.66 (16.8)	.080 (2.03)		
8274	16/14	.187 (4.8) × .020 (.51)	.58 (14.7)	.085 (2.16)		
8275		.250 (6.4) × .032 (.81)	.66 (16.8)	.080 (2.03)		

MALE VINYL INSULATED

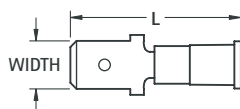

Hand Crimp Tool
CAT. NO. 1345

CAT. NO.	WIRE RANGE (AWG)	MALE TAB		L	BARREL		MAX INSULATION DIAMETER
		WIDTH × THICK	L		LENGTH	I.D.	
8286	22/18	.187 (4.8) × .020 (.51)	.85 (21.6)	.24 (6.3)	.080 (2.03)	.145 (3.7)	
8287	(Red)	.250 (6.4) × .032 (.81)	.93 (23.6)	.25 (6.4)	.065 (1.65)	.145 (3.7)	
8288	16/14	.187 (4.8) × .020 (.51)	.85 (21.6)	.24 (6.3)	.080 (2.03)	.145 (3.7)	
8289	(Blue)	.250 (6.4) × .032 (.81)	.93 (23.6)	.25 (6.4)	.085 (2.16)	.170 (4.3)	
8290	12/10 (Yellow)	.250 (6.4) × .032 (.81)	1.05 (26.7)	.25 (6.4)	.150 (3.8)	.250 (6.4)	

FEMALE VINYL INSULATED

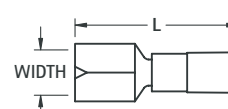
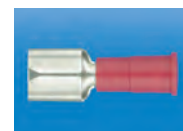

Hand Crimp Tool
CAT. NO. 1345

CAT. NO.	WIRE RANGE (AWG)	MATES WITH MALE TAB		L	BARREL .250 (6.4)		MAX INSULATION DIAMETER
		WIDTH × THICK	L		I.D.	I.D.	
8276	22/18	.187 (4.8) × .020 (.51)	.78 (19.8)	.085 (2.16)	.145 (3.7)		
8277	(Red)	.250 (6.4) × .032 (.81)	.87 (22.1)	.080 (2.03)	.145 (3.7)		
8278	16/14	.187 (4.8) × .020 (.51)	.78 (19.8)	.085 (2.16)	.145 (3.7)		
8279	(Blue)	.250 (6.4) × .032 (.81)	.87 (22.1)	.080 (2.03)	.145 (3.7)		
8280	12/10 (Yellow)	.250 (6.4) × .032 (.81)	.96 (24.4)	.165 (4.2)	.250 (6.4)		

MALE FULLY INSULATED NYLON

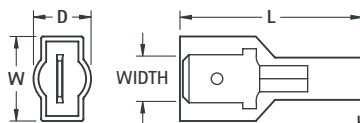

Hand Crimp Tool
CAT. NO. 1345

CAT. NO.	WIRE RANGE (AWG)	MALE TAB		L	W	D	BARREL .250 (6.4)		MAX. INSUL. DIA.
		WIDTH × THICK	L				LENGTH	I.D.	
8296	22/18	.187 (4.8) × .020 (.51)	.87 (22.1)	.37 (9.4)	.30 (7.6)	.24 (6.3)	.080 (2.03)	.145 (3.7)	
8297	(Red)	.250 (6.4) × .032 (.81)	.95 (24.1)	.44 (11.2)	.30 (7.6)	.25 (6.4)	.065 (1.65)	.145 (3.7)	
8298	16/14	.187 (4.8) × .020 (.51)	.87 (22.1)	.37 (9.4)	.30 (7.6)	.24 (6.3)	.080 (2.03)	.170 (4.3)	
8299	(Blue)	.250 (6.4) × .032 (.81)	.95 (24.1)	.44 (11.2)	.30 (7.6)	.25 (6.4)	.085 (2.16)	.170 (4.3)	
8300	12/10 (Yellow)	.250 (6.4) × .032 (.81)	1.05 (26.7)	.47 (11.9)	.39 (9.9)	.25 (6.4)	.150 (3.8)	.250 (6.4)	

FEMALE FULLY INSULATED NYLON

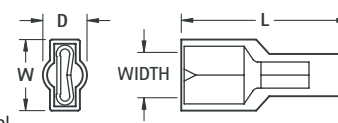

Hand Crimp Tool
CAT. NO. 1345

CAT. NO.	WIRE RANGE (AWG)	MATES WITH MALE TAB		L	W	D	BARREL .250 (6.4)		MAX. INSUL. DIA.
		WIDTH × THICK	L				I.D.	I.D.	
8291	22/18	.187 (4.8) × .020 (.51)	.81 (20.6)	.30 (7.6)	.23 (5.8)	.085 (2.16)	.145 (3.7)		
8292	(Red)	.250 (6.4) × .032 (.81)	.87 (22.1)	.37 (9.4)	.23 (5.8)	.080 (2.03)	.145 (3.7)		
8293	16/14	.187 (4.8) × .020 (.51)	.81 (20.6)	.30 (7.6)	.23 (5.8)	.085 (2.16)	.145 (3.7)		
8294	(Blue)	.250 (6.4) × .032 (.81)	.87 (22.1)	.37 (9.4)	.23 (5.8)	.080 (2.03)	.170 (4.3)		
8295	12/10 (Yellow)	.250 (6.4) × .032 (.81)	.99 (25.1)	.39 (9.9)	.32 (8.1)	.165 (4.2)	.250 (6.4)		