

.250 (6.4) "STURDI-MOUNT" PC QUICK-FIT HEADERS



AVAILABLE IN BRASS OR STEEL TABS

- Ideal for rugged multi-insertion applications
- Pre-assembled header reduces PC assembly costs
- Increases PC board retention strength
- Keeps terminals perpendicular
- Maintains position for wave soldering

SPECIFICATIONS

Material: .032 (.80) thick Brass or Steel, Tin Plated

Insulator: Thermoplastic, UL Rated 94V-0

Current Rating: 15 Amps @ 500V AC

Temperature Rating: -58°F to +292°F (-50°C to +145°C)



.250 (6.4) HORIZONTAL

BRASS TABS	STEEL TABS	NO. OF TABS	A DIM.
CAT. NO.	CAT. NO.		
7802	7822	2	.362 (9.2)
7803	7823	3	.562 (14.3)
7804	7824	4	.762 (19.4)
7805	7825	5	.962 (24.4)
7806	7826	6	1.162 (29.5)

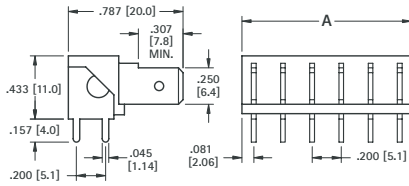

.250 (6.4) VERTICAL

BRASS TABS	STEEL TABS	NO. OF TABS	A DIM.
CAT. NO.	CAT. NO.		
7812	7832	2	.362 (9.2)
7813	7833	3	.562 (14.3)
7814	7834	4	.762 (19.4)
7815	7835	5	.962 (24.4)
7816	7836	6	1.162 (29.5)

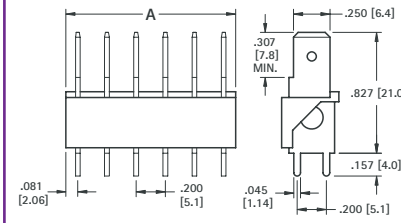

Mtg. Holes: .052 (1.3) Dia. on .200 (5.1) Centers

RIVET MOUNT QUICK-FIT TERMINALS



.110 (2.8) - .187 (4.8) - .250 (6.4) TABS

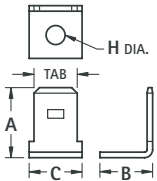

90° TAB

MATERIAL: Bright Brass

CAT. NO.	TAB SIZE	MAT'L THICK	A	B	C	HOLE DIA.
2002	.110 (2.8)	.020 (.51)	.375 (9.5)	.270 (6.9)	.180 (4.6)	.096 (2.4)
1261	.187 (4.8)	.020 (.51)	.375 (9.5)	.250 (6.4)	.250 (6.4)	.099 (2.5)
1256	.250 (6.4)	.032 (.81)	.405 (10.3)	.343 (8.7)	.312 (7.9)	.130 (3.3)

.110 (2.8) - .187 (4.8) - .250 (6.4) TABS

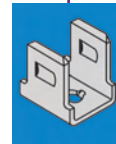
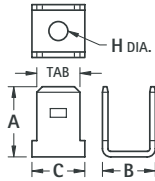

90° TABS

MATERIAL: Bright Brass

CAT. NO.	TAB SIZE	MAT'L THICK	A	B	C	HOLE DIA.
2003	.110 (2.8)	.020 (.51)	.350 (8.9)	.383 (9.7)	.180 (4.6)	.096 (2.4)
1262	.187 (4.8)	.020 (.51)	.312 (7.9)	.250 (6.4)	.250 (6.4)	.099 (2.5)
1257	.250 (6.4)	.032 (.81)	.405 (10.3)	.343 (8.7)	.312 (7.9)	.130 (3.3)

.250 (6.4) TAB

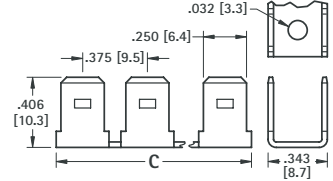

MULTIPLE 90° MATERIAL: Bright Brass

CAT NO.	PAIRS	C	TAB SIZE
1005	2	.687 (17.4)	.250 (6.4)
1006	3	1.062 (27.0)	
1007	4	1.441 (36.6)	
1008	5	1.820 (46.2)	

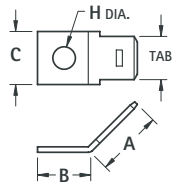

45° TAB

MATERIAL: Bright Brass

CAT. NO.	TAB SIZE	MAT'L THICK	A	B	C	HOLE DIA.
2004	.110 (2.8)	.020 (.51)	.350 (8.9)	.270 (6.9)	.180 (4.6)	.096 (2.4)
1271	.187 (4.8)	.020 (.51)	.375 (9.5)	.250 (6.4)	.250 (6.4)	.099 (2.5)
1280	.250 (6.4)	.032 (.81)	.405 (10.3)	.312 (7.9)	.312 (7.9)	.130 (3.3)

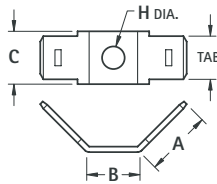

45° TABS

MATERIAL: Bright Brass

CAT. NO.	TAB SIZE	MAT'L THICK	A	B	C	HOLE DIA.
2005	.110 (2.8)	.020 (.51)	.350 (8.9)	.383 (9.7)	.180 (4.6)	.096 (2.4)
1263	.187 (4.8)	.020 (.51)	.312 (7.9)	.375 (9.5)	.265 (6.7)	.099 (2.5)
1258	.250 (6.4)	.032 (.81)	.405 (10.3)	.343 (8.7)	.312 (7.9)	.130 (3.3)

.110 (2.8) TAB

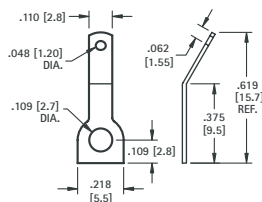

30° TAB

CAT. NO. 1270

MATERIAL: .020 (.51) thick Brass, Tin Plate

.187 (4.8) - .205 (6.4) TABS

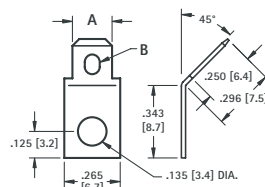

45° TAB MATERIAL: .020 (.51) thick Brass, Tin Plate

CAT. NO.	A	B
4005	.205 (5.2)	.132 (3.4) × .070 (1.78) Slot
4095	.187 (4.7)	.078 (1.98) Dia. Hole

.250 (6.4) MALE TAB INSERTION TOOL

Designed to install .250 (6.4) male "Quick-Fit" terminals quickly and easily. Refer to pages 44 and 45.

- Insert terminal into slot, spring clip will hold terminal securely for positioning
- Align terminal with mounting holes and "press-fit" to secure firmly in place
- Lift tool to release terminal

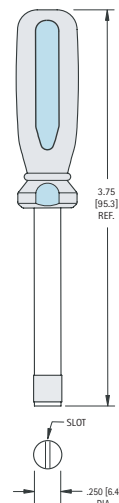

CAT. NO. 1288

FEMALE PC QUICK-FIT TERMINALS

FEMALE PC QUICK-FIT TERMINALS

ACCEPTS .110 (2.8) TAB

HORIZONTAL ENTRY

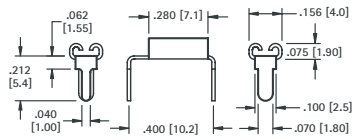

MATERIAL:

.012 (.30) thick Brass,
Tin Nickel Plate

Mounting Detail

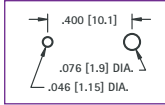

CAT. NO.	ACCEPTS TAB
3545	.110 (2.8) × .020 (.50)
3549	.110 (2.8) × .032 (.80)

ACCEPTS .205 (5.2) TAB

HORIZONTAL ENTRY

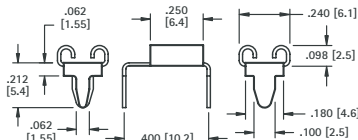

MATERIAL:

.012 (.30) thick Brass,
Tin Nickel Plate

Mounting Detail

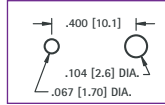

CAT. NO.	ACCEPTS TAB
3546	.205 (5.2) × .020 (.50)
3550	.205 (5.2) × .032 (.80)

ACCEPTS .250 (6.4) TAB

HORIZONTAL ENTRY

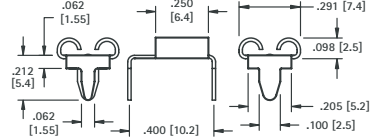

MATERIAL:

.016 (.41) thick Brass,
Tin Nickel Plate

Mounting Detail

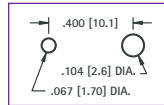

CAT. NO.	ACCEPTS TAB
3547	.250 (6.4) × .032 (.80)

ACCEPTS .110 (2.8) TAB

VERTICAL ENTRY

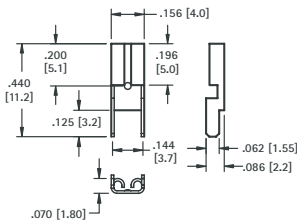

MATERIAL:

.012 (.30) thick Brass,
Tin Nickel Plate

Mounting Detail

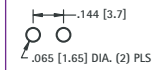

CAT. NO.	ACCEPTS TAB
3534	.110 (2.8) × .020 (.50)
3544	.110 (2.8) × .032 (.80)

ACCEPTS .205 (5.2) TAB

VERTICAL ENTRY

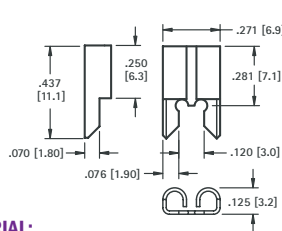

MATERIAL:

Brass, Tin Nickel Plate

Mounting Detail

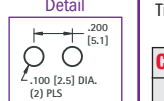

CAT. NO.	ACCEPTS TAB	MAT'L THICK
3525	.205 (5.2) × .020 (.50)	.012 (.30)
3522	.205 (5.2) × .025 (.60)	.016 (.40)
	.205 (5.2) × .032 (.80)	.016 (.40)

ACCEPTS .250 (6.4) TAB

VERTICAL ENTRY

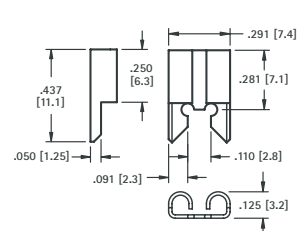

MATERIAL:

.016 (.41) thick Brass,
Tin Nickel Plate

Mounting Detail

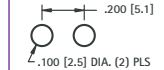

CAT. NO.	ACCEPTS TAB
3528	.250 (6.4) × .032 (.80)

ACCEPTS .187 (4.8) TAB

VERTICAL ENTRY

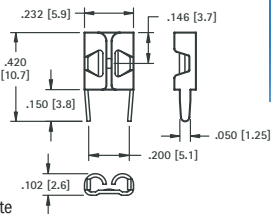

MATERIAL:

.016 (.41) thick
Brass, Tin Nickel Plate

Mounting Detail

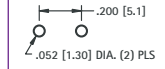

CAT. NO.	ACCEPTS TAB
3548	.187 (4.8) × .020 (.50)
3551	.187 (4.8) × .032 (.80)

ACCEPTS ALL TABS

VERTICAL OR HORIZONTAL ENTRY

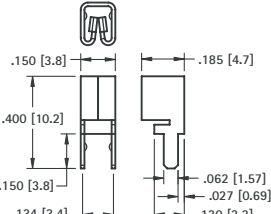

MATERIAL:

.016 (.41) thick Brass,
Tin Nickel Plate

Mounting Detail

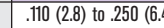

CAT. NO.	ACCEPTS TAB
3557	.110 (2.8) to .250 (6.4) × .020 (.50) to .032 (.80)

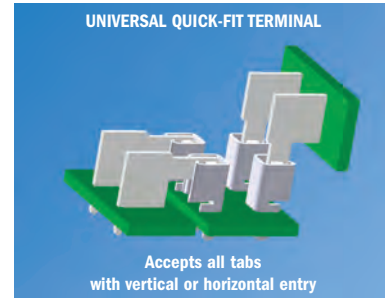

Mounting Detail

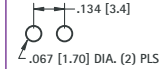

MULTI-PURPOSE HAND TOOL

- This Multi-purpose tool is all that is required to crimp wires into solderless terminals. Refer to pages 48 and 49.

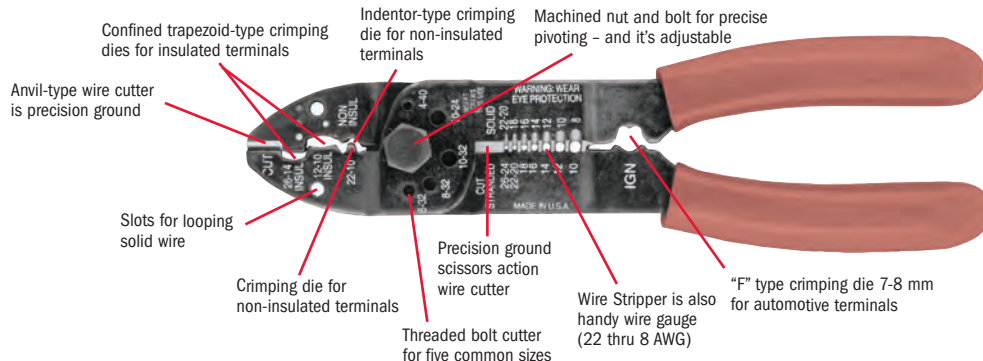

CAT. NO. 1345

Tel (718) 956-8900 • Fax (718) 956-9040
(800) 221-5510 • kec@keyelco.com

KEYSTONE
RoHS COMPLIANT ~ ISO 9001 CERTIFIED

www.keyelco.com
31-07 20th Road - Astoria, NY 11105-2017