

# PC BUTTON & SPRING CONTACTS

- Ideal contacts for "A" · "AA" · "AAA" · "N" size batteries
- Space saving design installs directly onto the PC board
- Contacts available for .062 (1.57) to .093 (2.36) thick PC boards
- Reliable spring and/or button assures low contact resistance
- Ideal for self-contained battery compartments



Refer to page 24 for  
Battery Contact Layout & Mounting Details

For "A"

For "AA" · "AAA" · "N"

(+) POSITIVE BUTTON

(-) NEGATIVE SPRING

(+) POSITIVE BUTTON

(-) NEGATIVE SPRING

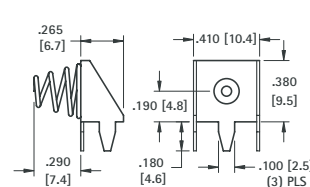
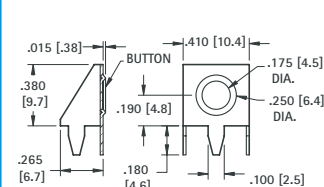
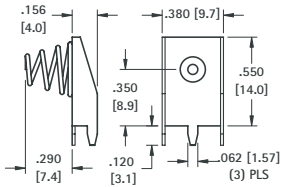
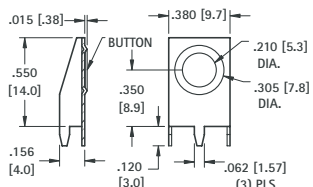

Mounting Detail

Mounting Detail

**MATERIAL:**  
Frame: .015 (.38) thick  
Steel, Tin Nickel Plate

**MATERIAL:**  
Frame: .015 (.38) thick  
Steel, Tin Plate

**MATERIAL:**  
Frame: .015 (.38) thick  
Steel, Tin Nickel Plate

**MATERIAL:**  
Frame: .015 (.38) thick  
Steel, Tin Plate

CAT. NO. 595

CAT. NO. 628

CAT. NO. 637

CAT. NO. 629

## SNAP-IN PC BUTTON & LEAF-SPRING CONTACTS



- Space saving design installs directly onto the PC board
- Suitable for .062 (1.57) to .093 (2.36) thick PC boards
- Reliable leaf-spring assures low contact resistance
- Ideal for self-contained battery compartments



**MATERIAL:** .012 (.30) thick Spring Steel, Tin Nickel Plate

For "AA" & "N"

Refer to page 24 for  
Battery Contact Layout & Mounting Details

For "AAA"

(+) POSITIVE BUTTON

(-) NEGATIVE LEAF-SPRING

(+) POSITIVE BUTTON

(-) NEGATIVE LEAF-SPRING

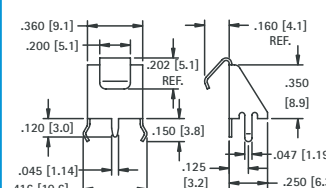
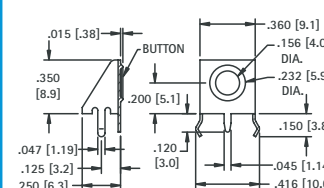
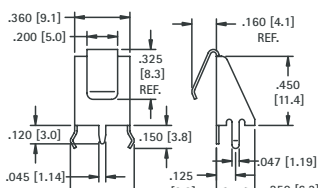
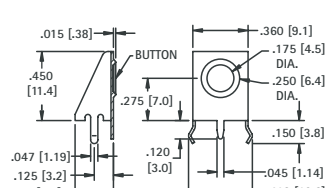

Mounting Detail

Mounting Detail

CAT. NO. 596

CAT. NO. 590

CAT. NO. 597

CAT. NO. 591

## SURFACE MOUNT LEAF-SPRING CONTACTS

AVAILABLE ON TAPE AND REEL

- Economical & reliable contacts are ideal for surface mount applications
- Unique spring tension contacts adjust to variations in battery length
- Reliable spring tension contacts assure low contact resistance
- SMT solder tail with "flow-hole" design for increased joint strength

**MATERIAL:** .010 (.25) thick Spring Steel, Tin Nickel Plate

For "AAA" · "AAAA"

Refer to page 24 for  
Battery Contact Layout & Mounting Details

For "A" · "AA" · "9V"

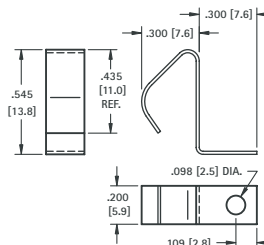
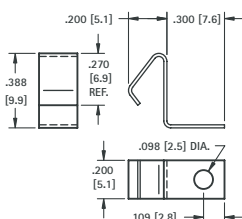

CAT. NO. 5230 (Bulk)

CAT. NO. 5230TR (Tape & Reel)

Tape and Reel Spec's: 24mm wide; 12mm pitch; 13 inch reel (400 pieces per reel)

CAT. NO. 5231 (Bulk)

CAT. NO. 5231TR (Tape & Reel)

Tape and Reel Spec's: 32mm wide; 16mm pitch; 13 inch reel (250 pieces per reel)