

INSULATED PC SPACERS/SUPPORTS

- Board will be electrically insulated, eliminates need for insulating washers
- Easy snap-in assembly
- No tool required for installation
- Designed for .062 (1.57) thick boards

- One pieces design eliminates the need for additional screws and nuts
- Slim design frees up board space

TENSION-FIT



- One end permanently attaches to chassis
- Other end secures board with tension fit.
- Board easily releasable for repairs or upgrades

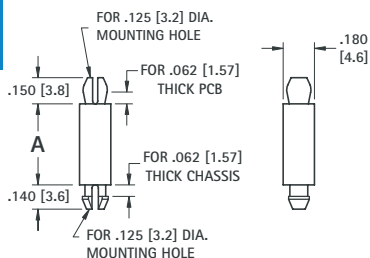

CAT. NO.	A LENGTH
8879	.125 (3.2)
8880	.187 (4.7)
8881	.250 (6.4)
8882	.375 (9.5)
8883	.500 (12.7)
8884	.625 (15.9)
8885	.750 (19.1)
8886	.875 (22.2)
8887	1.000 (25.4)

MATERIAL: Nylon 6/6, UL Rated 94V-0

EASY LOCK-IN



- Both ends permanently attach to chassis and board
- Teardrop style mounting end eases assembly
- Low protrusion above board and under chassis

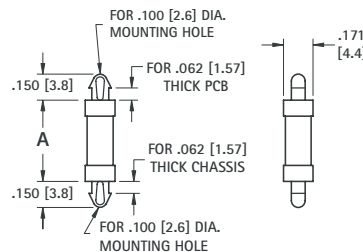

CAT. NO.	A LENGTH
8888	.125 (3.2)
8889	.187 (4.7)
8890	.250 (6.4)
8891	.375 (9.5)
8892	.500 (12.7)
8893	.625 (15.9)

MATERIAL: Nylon 6/6, UL Rated 94V-0

LOCK-IN



- Both ends permanently attach to chassis and board
- Secure mounting end design allows for taller spacing

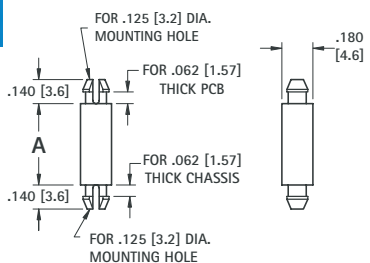

CAT. NO.	A LENGTH
9018	.125 (3.2)
9019	.187 (4.7)
9020	.250 (6.4)
9021	.375 (9.5)
9022	.500 (12.7)
9023	.625 (15.9)
9024	.750 (19.1)
9025	.875 (22.2)
9026	1.000 (25.4)

MATERIAL: Nylon 6/6, UL Rated 94V-0

METRIC LOCK-IN



- Both ends permanently attach to chassis and board
- Designed specifically for metric mounting holes and spacing

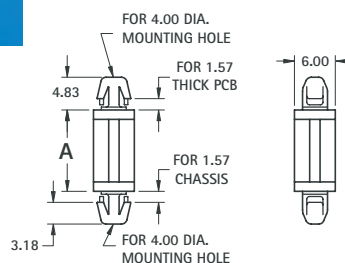

CAT. NO.	A LENGTH
8843	3.0
8844	4.0
8845	6.0
8846	8.0
8847	10.0
8848	12.0
8849	14.0
8850	16.0
8851	18.0

MATERIAL: Nylon 6/6, UL Rated 94V-0

THRU HOLE SPACERS

One end locks into panel. Clear hole designs for #4, #6 or #8 screw.



- Base has larger surface area. Will not deform under heavy pre-load.

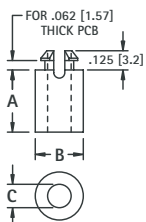

CAT. NO.	A LENGTH	Outside Diameter	Inside Diameter	Mounting Hole	Screw Size
9027	.125 (3.2)				
9028	.187 (4.7)				
9029	.250 (6.4)	.260 (6.6)	.125 (3.2)	.187 (4.7)	#4
9030	.375 (9.5)				
9031	.500 (12.7)				
9032	.625 (15.9)				
9033	.250 (6.4)				
9034	.375 (9.5)	.312 (7.9)	.153 (3.9)	.234 (5.9)	#6
9035	.500 (12.7)				
9036	.625 (15.9)				
9037	.250 (6.4)				
9038	.375 (9.5)	.312 (7.9)	.169 (4.3)	.234 (5.9)	#8
9039	.500 (12.7)				
9040	.625 (15.9)				

MATERIAL: Nylon 6/6, UL Rated 94V-0

STACKING SPACERS

One end locks into panel. Clear hole designs for #4, #6 or #8 screw.



- Spacers can be stacked for multiple level PC board applications
- Self-aligning

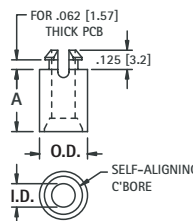

CAT. NO.	A LENGTH	Outside Diameter	Inside Diameter	Mounting Hole	Screw Size
8829	.125 (3.2)				
8830	.187 (4.7)				
8831	.250 (6.4)	.260 (6.6)	.125 (3.2)	.187 (4.7)	#4
8832	.375 (9.5)				
8833	.500 (12.7)				
8834	.625 (15.9)				
8835	.250 (6.4)				
8836	.375 (9.5)	.312 (7.9)	.153 (3.9)	.234 (5.9)	#6
8837	.500 (12.7)				
8838	.625 (15.9)				
8839	.250 (6.4)				
8840	.375 (9.5)	.312 (7.9)	.169 (4.3)	.234 (5.9)	#8
8841	.500 (12.7)				
8842	.625 (15.9)				

MATERIAL: Nylon 6/6, UL Rated 94V-0

INSULATED PC SPACERS/SUPPORTS