

# SURFACE MOUNT AUDIO JACKS

- Mates with 2.5mm and 3.5mm plugs
- Designed for reliable interface with audio equipment including computer speakers, headphones, sound cards, cell phones, etc.
- Models available for mono and stereo applications
- Low profile, surface mount design

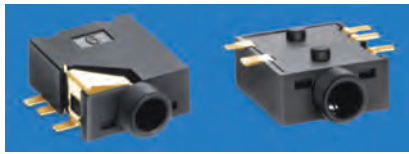

## SPECIFICATIONS

- Housing:** Polyamide, UL Rated 94V-0
- Ground Terminal:** .012 (.30) thick Brass, Gold Flash ①
- Spring Contacts:** .008 (.20) thick Phosphor Bronze, Gold Flash ② ⑤
- Shunt Terminals:** .012 (.30) thick Brass, Gold flash ③ ④

### FOR 2.5 mm PLUGS

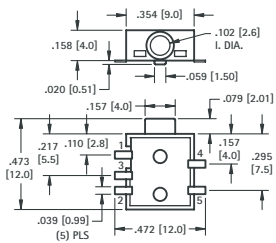

**CAT. NO. 980TR** (Stereo)

**CAT. NO. 982TR** (Mono)

**Tape Spec's:** 24mm wide; 16mm pitch  
**Reel Spec's:** 15 inch reel (1,000 pieces per reel)

### SUPPLIED ON TAPE AND REEL

#### Pad Layout

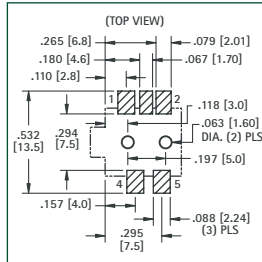

#### STEREO SCHEMATIC



### FOR 3.5 mm PLUGS

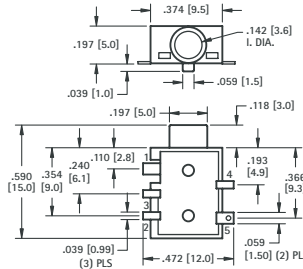

**CAT. NO. 981TR** (Stereo)

**CAT. NO. 983TR** (Mono)

**Tape Spec's:** 24mm wide; 16mm pitch  
**Reel Spec's:** 15 inch reel (800 pieces per reel)

#### Pad Layout

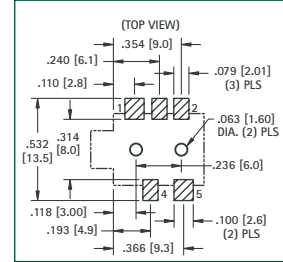

## "F" FEMALE CONNECTOR

### SNAP-FIT PC MOUNT

- Low profile
- Snap-fit mounting for positive retention during wave soldering
- Rugged, stable construction facilitates reliable mating
- High reliability, manufactured using Nickel Plated Brass bodies and Tin Plated Phosphor Bronze contacts
- Supplied with washer and nut

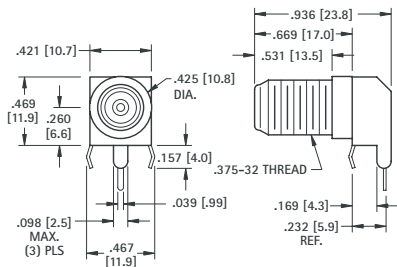

#### Mounting Detail

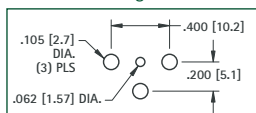

**CAT. NO. 911**

## PANEL MOUNT PHONO JACKS

- Mates with .125 (3.12) dia. pin
- Color coded for ease of identification
- Mounts to panel in .296 (7.6) dia. hole
- Complete with nut and solder lug

### ROUND BASE

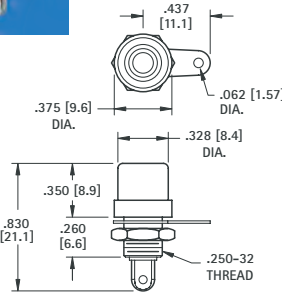

CAT. NO.	INSULATOR COLOR
580	RED
574	BLACK

### HEX BASE

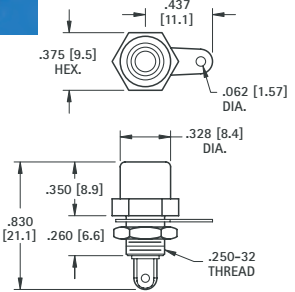

CAT. NO.	INSULATOR COLOR
581	WHITE
582	RED
576	BLACK
583	YELLOW

**MATERIAL:** Brass, Nickel Plate

## COLOR KEYED - PC PHONO JACKS

- Mates with .125 (3.2) diameter pins
- Features a normally closed circuit
- Various colors for circuit identification
- Snap-fit mounting for positive retention during wave soldering

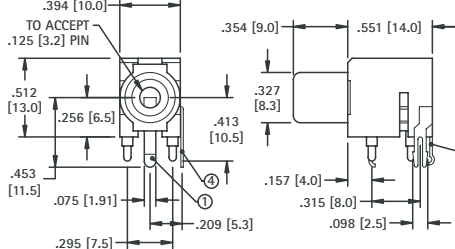

CAT. NO.	INSULATOR COLOR
970	WHITE
971	RED
972	BLACK
973	YELLOW

### SPECIFICATIONS

- Housing:** PBT
- Ground Terminal:** .020 (.51) thick Brass, Nickel Plate ①
- Spring Contact:** .012 (.30) thick Phosphor Bronze, Silver Plate ③
- Shunt Terminal:** .016 (.41) thick Brass, Silver Plate ④

### SCHEMATIC



#### Mounting Detail

