

ACCEPTS .080 (2.0) TIP WITH CLOSED ENTRY CONTACT

Fully molded body with recessed closed entry design. Assures maximum retention with .010Ω maximum contact resistance. Prevents accidental insertion of larger diameter probes. Current rating: 10 Amps. Breakdown voltage 5700V RMS. Capacitance to metal panel 2.0 pF nominal. Supplied with nut.

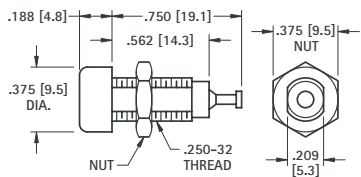

CAT. NO.	COLOR
6030	WHITE
6031	RED
6032	BLACK
6033	GREEN
6034	YELLOW
6035	BLUE

MATERIAL:

Body: Molded Nylon ASTM D4066  
 Contact: Beryllium Copper, Silver Plate  
 Terminal: Brass, Tin Plate

ACCEPTS .080 (2.0) TIP

Economical tip jacks with molded Nylon body. Low contact resistance. Formed Phosphor Bronze contact with solder hole for ease in attaching wire. Current rating 10 Amps. Breakdown voltage 5700 VRMS. Capacitance to metal panel 3.8 pF. Supplied with nut.

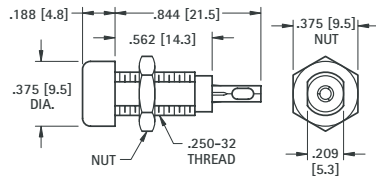

CAT. NO.	COLOR
6018	WHITE
6019	RED
6020	BLACK
6021	GREEN
6022	YELLOW
6023	BLUE

MATERIAL:

Body: Molded Nylon ASTM D4066  
 Contact: Phosphor Bronze, Tin Plate

METAL-CLAD TIP JACK (MIL)

ACCEPTS .080 (2.0) TIP WITH CLOSED ENTRY CONTACT

High quality tip jack for high reliability industrial applications. Ideal for use where required to withstand severe environmental conditions, temperature, vibration and salt spray. Recessed closed entry contact. Current rating 10 amps. Breakdown voltage: 5700V RMS. Made to MIL-C39024/10. Capacitance to metal panel 2.0 pF Supplied complete with hardware.

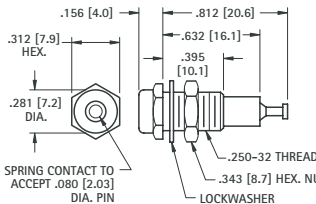

MATERIAL:

Body: Molded Nylon ASTM D4066  
 Shell & Nut: Brass QQ-B-626, Nickel Plate QQ-N-290  
 Contact: Beryllium Copper for QQ-C-533. Gold Plate MIL-G-45204

CAT. NO.	COLOR
6012	WHITE
6013	RED
6014	BLACK
6015	GREEN
6016	YELLOW
6017	BLUE

METAL-CLAD TIP JACK (STD)

ACCEPTS .080 (2.0) TIP

Molded Nylon body with metal jacket. Contact is formed from phosphor bronze contact with solder hole for ease in attaching wire. Designed for positive contact, easy insertion and withdrawal. Current rating: 10 Amps. Breakdown voltage 5700V RMS. Capacitance to metal panel 3.8 pF. Supplied with nut.

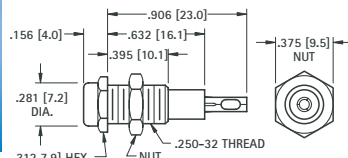

MATERIAL:

Body: Molded Nylon ASTM D4066  
 Shell: Brass, Nickel Plate  
 Contact: Phosphor Bronze, Silver Plate

CAT. NO.	COLOR
6024	WHITE
6025	RED
6026	BLACK
6027	GREEN
6028	YELLOW
6029	BLUE

UNINSULATED TIP JACK

ACCEPTS .080 (2.0) TIP

Quality, precision machined tip jack made of brass. Ideal for use on metal panels where grounding is required. Fits panels up to .375 (9.5) thick. Supplied with nut.

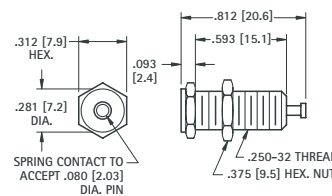

MATERIAL:

Body: Brass, Nickel Plate  
 Contact: Beryllium Copper  
 Current Rating: 15 Amps

CAT. NO. 6097

PLUGS & JACKS

SOLDER TIP PLUGS

.080 (2.0) DIAMETER TIP



Designed for miniaturization where space is critical. Solder lead connection. Maximum reliability with minimum contact resistance. Base of tip is recessed to eliminate shock or grounding. Fits all standard jacks.

MATERIAL:

Tip: Brass, Nickel Plate  
 Handle: Nylon 6/6  
 Current Rating: 10 Amps.

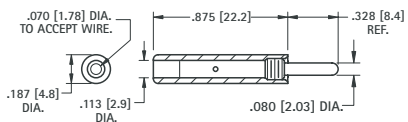

CAT. NO.	COLOR	CAT. NO.	COLOR
6006	WHITE	6009	GREEN
6007	RED	6010	YELLOW
6008	BLACK	6011	BLUE

SOLDERLESS TIP PLUGS

.080 (2.0) DIAMETER TIP



Fully insulated molded nylon sleeve. Maximum reliability with minimum contact resistance. Recessed metal head eliminates possibility of shock or grounding. Designed for solderless connection of up to 16 gauge stranded wire which fits through handle and tip and is secured by screwing handle tight. Fits all standard tip jacks.

MATERIAL:

Tip: Brass, Nickel Plate  
 Handle: Nylon 6/6  
 Current Rating: 10 Amps.

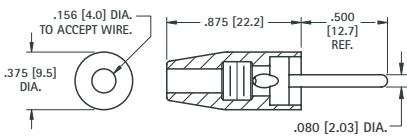

CAT. NO.	COLOR	CAT. NO.	COLOR
6000	WHITE	6003	GREEN
6001	RED	6004	YELLOW
6002	BLACK	6005	BLUE

STANDARD PHONE TIP

.080 (2.0) DIAMETER TIP



Accepts up to 12 gauge wire. Fits all standard tip jacks.

MATERIAL: Brass, Nickel Plate

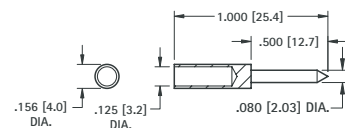

CAT. NO. 1601

## VERTICAL PC TEST JACK

ACCEPTS .080 (2.0) TIP

This low profile vertical jack allows dense packaging where space is limited. Mount into a .052 (1.32) diameter hole. Provides easy access and positive electrical contact. The contact is recessed to prevent accidental shorting. Capacitance between two adjacent jacks less than 1.0 pF at 1 MHz. Operating voltage is 1500V RMS. Current rating 5 Amps max.

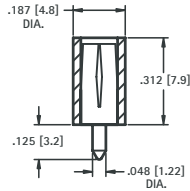

CAT. NO.	COLOR
6036	WHITE
6037	RED
6038	BLACK
6039	YELLOW
6040	GREEN
6041	BLUE

**MATERIAL:**

Body: Nylon per ASTM D4066

Contact: Brass, Silver Plate

## SNAP-FIT VERTICAL PC TEST JACK

ACCEPTS .080 (2.0) TIP

Low cost, compact and dependable snap-in vertical test jack features a unique spring shank which retains the jack throughout wave soldering procedure. Ideal for use on circuit boards of audio, digital and R.F. circuitry. Contact recessed to prevent accidental shorting. Current rating: 5 Amps. Operating voltage 1500V RMS. Capacitance between two adjacent jacks less than 1.0 pF at 1 MHz.

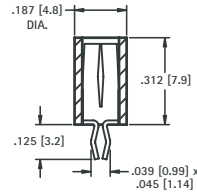

CAT. NO.	COLOR
6042	WHITE
6043	RED
6044	BLACK
6045	YELLOW
6046	GREEN
6047	BLUE

**MATERIAL:**

Body: Nylon per ASTM D4066

Contact: Beryllium Copper, Silver Plate

Mounting: Snap-fits into .052 (1.32) hole

## MINIATURE HORIZONTAL PC TEST JACK

ACCEPTS .080 (2.0) TIP

Space saver test jack designed for use where space is a limiting factor. Half the size of standard jacks. Accepts .080 (2.03) tip plug in either end. Mounts on .200 (5.1) centers in .052 (1.32) holes. Can be spaced side by side on .160 (4.1) centers minimum. Two common terminals. Current rating: 5 Amps. Breakdown voltage: 2100V RMS, Capacitance 1.0pF maximum.

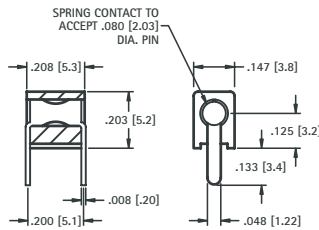

CAT. NO.	COLOR
6048	WHITE
6049	RED
6050	BLACK
6051	YELLOW
6052	GREEN
6053	BLUE

**MATERIAL:**

Body: Nylon per ASTM D4066

Contact: Beryllium Copper, Silver Plate

## UNIVERSAL HORIZONTAL PC TEST JACK

ACCEPTS .080 (2.0) TIP

This universal design accepts .080 (2.03) tip plug in either end, or from top or bottom. Top contact will also accept hook-type oscilloscope probe. Two common terminals. Current rating: 5 Amps. Breakdown voltage: 2100V RMS, Capacitance 1.0 pF maximum. Mounts on .400 (10.2) centers in .052 (1.32) holes. Side by side mounting on .160 (4.1) centers.

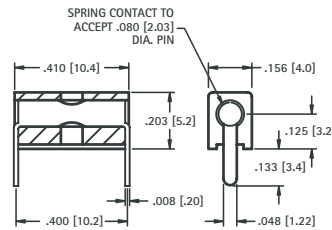

CAT. NO.	COLOR
6054	WHITE
6055	RED
6056	BLACK
6057	YELLOW
6058	GREEN
6059	BLUE

**MATERIAL:**

Body: Nylon per ASTM D4066

Contact: Beryllium Copper, Silver Plate

## LOW PROFILE HORIZONTAL PC TEST JACK

ACCEPTS .080 (2.0) TIP

This low profile double-entry design is recognized for its dependability, and allows dense packaging on .160 (4.1) centers. Side by side mounting. Closed entry design for use with .074 (1.88) to .084 (2.13) dia. tips. Reliability is designed into this rugged low cost jack. Mounts on .400 (10.2) centers in .052 (1.32) holes. Current rating: 5 Amps. Breakdown voltage: 2100V RMS. Contact resistance .010Ω maximum.

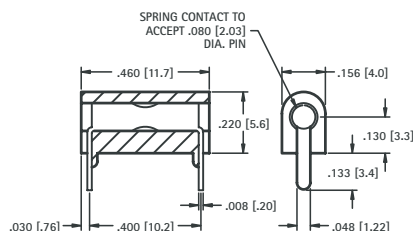

GOLD PLATE CAT. NO.	COLOR	SILVER PLATE CAT. NO.
6060	WHITE	6066
6061	RED	6067
6062	BLACK	6068
6063	YELLOW	6069
6064	GREEN	6070
6065	BLUE	6071

**MATERIAL:**

Body: Nylon per ASTM D4066

Contact: Beryllium Copper, Gold or Silver Plate