

ACTUAL SIZE

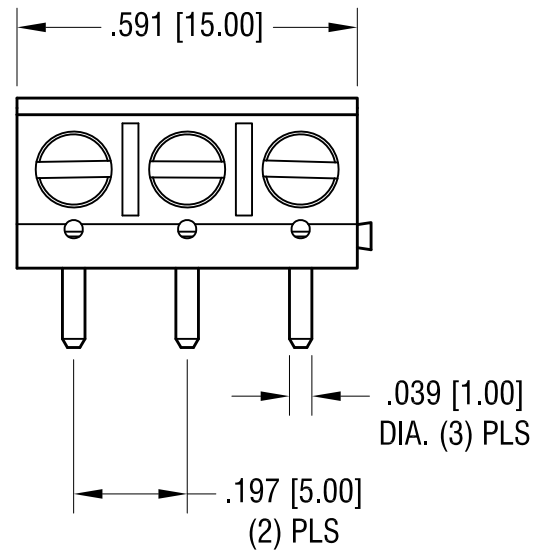
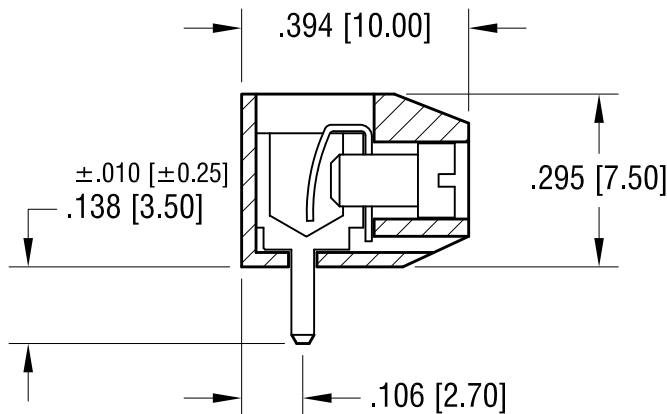
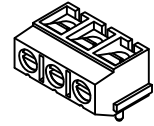
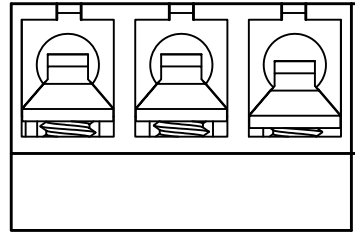

NOTES:

- MAT'L:**
HOUSING: PA66, UL 94V-0
CONTACT: BRASS, TIN PLATE
SCREW, CAPTIVATED: STEEL, ZINC PLATE
- RECOMMENDED MOUNTING HOLE:**
.047 [1.19] DIA. (3) PLS

7.26.22	MAT'L WAS PBT CHANGE AS PER ECN 22-130	A
DATE	DESCRIPTION	REV.

KEYSTONE ELECTRONICS CORP.			
www.keyelco.com • NEW HYDE PARK NY 11040 • Tel (516) 326-7500			
PART NAME			
5mm PC TERMINAL BLOCK			
MATERIAL			
AS NOTED			
FINISH		DRN BY	DATE
AS NOTED		BOONE	1.30.07
		APP'D	SCALE
		RH	3X
TOLERANCES	INCH [MM]	CODE	DWG NO.
DECIMAL	$\pm .005 [\pm 0.13]$	C	8739
ANGULAR	$\pm 1^\circ$		
UNLESS OTHERWISE SPECIFIED			