

ACTUAL SIZE

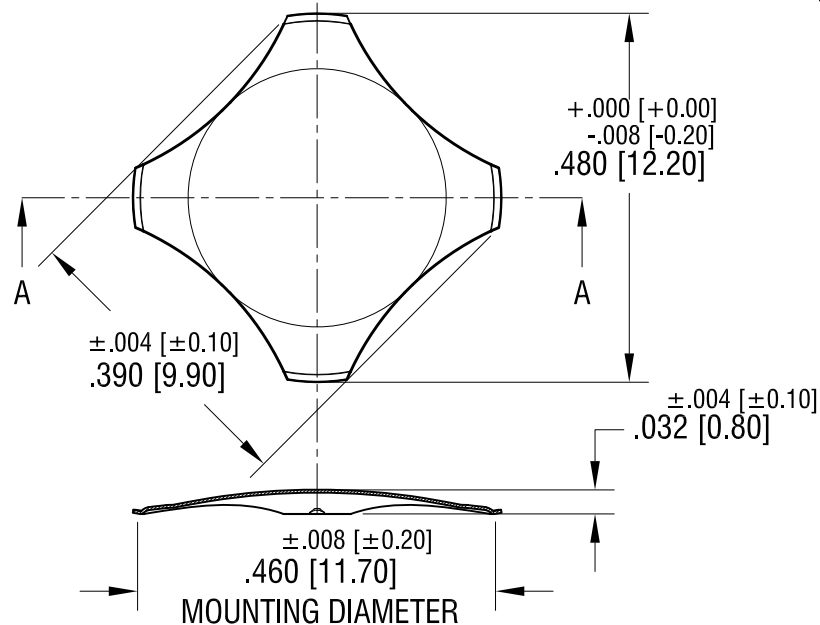
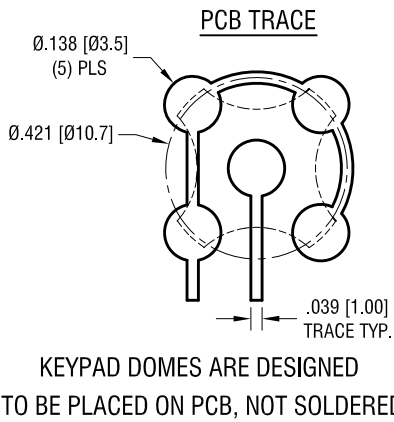

NOTE:

1. VOLTAGE/CURRENT MAXIMUM: 12mA@ 24 Volts DC
2. OPERATING TEMPERATURE: -40°F [-40°C] TO 220°F [105°C]
3. STORAGE TEMPERATURE: -65°F [-55°C] TO 250°F [125°C]
4. TRIP FORCE: 400g

KEYSTONE ELECTRONICS CORP.

www.keyelco.com • NEW HYDE PARK NY 11040 • Tel (516)328-7500

PART NAME

MAXI 4 LEG DOME

MATERIAL

.004 [0.10] TH'K STAINLESS STEEL

FINISH

NICKEL PLATE

DRN BY

NT

DATE

3.30.17

APP'D

RH

SCALE

5X

TOLERANCES

INCH [MM]

DECIMAL

±.005 [±0.13]

ANGULAR

± 1°

UNLESS OTHERWISE SPECIFIED

CODE

C

DWG NO.

5176

1.19.21 SUPPLIED IN BULK WAS SUPPLIED
IN TUBE
CHANGE AS PER ECN 22-029

A

REV.

DATE

DESCRIPTION